

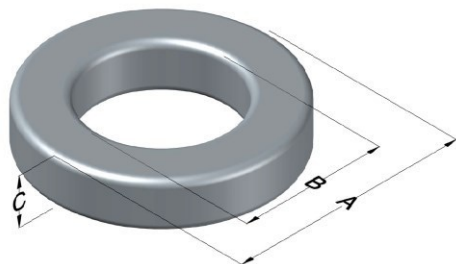

0078350A7

110 Delta Drive
 Pittsburgh, PA 15238
 NAFTA Sales: (1)800-245-3984
 HK Sales : (852)3102-9337
 magnetics@spang.com
 www.mag-inc.com



XFLUX Permeability (μ)	A_L (nH/T ²)	Core Marking			Coating Color
		Lot Number	Part Number	Inductance Grade	
125	105 \pm 8%	XXXXXX	78350A7	N/A	Brown

Dimensions						Packaging Cardboard cut-outs Box Qty = 720 Pcs
Uncoated			Coated Limits			
	(mm)	(in)	(mm)	(in)		
OD (A)	23.57	0.928	24.33	0.958	max	
ID (B)	14.40	0.567	13.77	0.542	min	
HT (C)	8.89	0.350	9.65	0.380	max	

Electrical Characteristics			Physical Characteristics						
Watt Loss @ 50kHz, 100mT (typ, mW/cm ³)	DC Bias typ (Oersteds)		Voltage Breakdown wire-to-wire min (V _{AC})	Break Strength (min, kg)	Window Area, W _A (mm ²)	Cross Section, A _e (mm ²)	Path Length, L _e (mm)	Volume V _e (mm ³)	Weight (g)
	80%	50%							
550	40	70	1000	47.1	147	38.8	58.8	2280	17.1

Winding Information					Temperature Rating				
Winding Length per Turn				Wound Coil Dimensions (mm)		Curie Temp (°C):	700 °C		
Winding Factor	(mm)	Winding Factor	(mm)	40% Winding Factor	OD	26.7	Coating Temp: (Continuous, up to; °C)	200 °C	
					HT	14.2			
0%	29.8	40%	36.9	Completely Full Window	Max OD	33.5	Notes:		
20%	33.4	45%	38.0		Max HT	21.4			
25%	34.2	50%	38.9	Surface Area (mm ²)					
30%	35.0	60%	41.1	Unwound Core:	1800				
35%	36.1	70%	43.6	40% Wound:	2700				

