

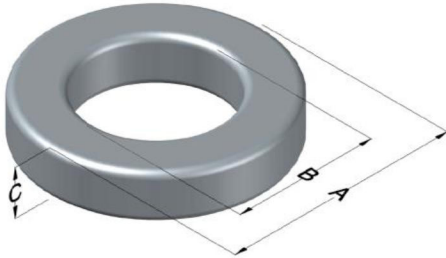

0078215A7

110 Delta Drive
 Pittsburgh, PA 15238
 NAFTA Sales: (1)800-245-3984
 HK Sales : (852)3102-9337
 magnetics@spang.com
 www.mag-inc.com



XFLUX Permeability (μ)	A _L (nH/T ²)	Core Marking			Coating Color
		Lot Number	Part Number	Inductance Grade	
19	24 ± 8%	XXXXXX	78215A7	N/A	Brown

Dimensions	Uncoated		Coated Limits			Packaging
	(mm)	(in)	(mm)	(in)		
OD (A)	57.15	2.250	58.04	2.285	max	Cardboard cut-outs Box Qty= 90 pcs
ID (B)	35.56	1.400	34.75	1.368	min	
HT (C)	13.97	0.550	14.86	0.585	max	

Electrical Characteristics			Physical Characteristics						
Watt Loss @ 50 kHz, 50mT max(mW/cm ³)	DC Bias min (oersteds)		Voltage Breakdown wire to wire min (V _{AC})	Break Strength min (kg)	Window Area W _A (mm ²)	Cross Section A _e (mm ²)	Path Length L _e (mm)	Volume V _e (mm ³)	Weight (g)
	215	80%							
	290	575							

Winding Information					Temperature Rating				
Winding Length Per Turn				Wound Coil Dimensions (mm)			Curie Temp: 700°C		
Winding Factor	(mm)	Winding Factor	(mm)	40% Winding Factor		OD	63.5	Coating Temp (Continuous up to): 200°C	
				HT	25.9				
				Completely Full Window		Max OD	81.3	Notes:	
						Max HT	44.4		
				Surface Area (mm ²)					
				Unwound Core		7,700			
				40% Winding Factor		13,000			
0%	53.0	40%	71.0						
20%	61.9	45%	73.2						
25%	64.3	50%	76.0						
30%	65.8	60%	81.3						
35%	68.7	70%	87.1						

