

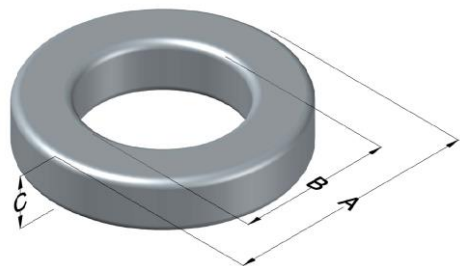

0078212A7

110 Delta Drive
 Pittsburgh, PA 15238
 NAFTA Sales: (1)800-245-3984
 HK Sales : (852)3102-9337
 magnetics@spang.com
 www.mag-inc.com



XFLUX Permeability (μ)	A_L (nH/T ²)	Core Marking			Coating Color
		Lot Number	Part Number	Inductance Grade	
40	50 \pm 8%	XXXXXX	78212A7	N/A	Brown

Dimensions					Packaging
Uncoated		Coated Limits			
	(mm)	(in)	(mm)	(in)	
OD (A)	57.15	2.250	58.04	2.285	Cardboard cut-outs Box Qty = 90 Pcs
ID (B)	35.56	1.400	34.75	1.368	
HT (C)	13.97	0.550	14.86	0.585	

Electrical Characteristics			Physical Characteristics						
Watt Loss @ 50kHz, 100mT (max, mW/cm ³)	DC Bias min (Oersteds)		Voltage Breakdown wire-to-wire min (V _{AC})	Break Strength (min, kg)	Window Area, W _A (mm ²)	Cross Section, A _e (mm ²)	Path Length, L _e (mm)	Volume V _e (mm ³)	Weight (g)
	80%	50%							
850	120	230	2000	106.5	948	144	143	20600	154.3

Winding Information					Temperature Rating	
Winding Length per Turn			Wound Coil Dimensions (mm)		Curie Temp (°C):	
Winding Factor	(mm)	Winding Factor	(mm)	40% Winding Factor	OD	63.5
					HT	25.9
0%	53.0	40%	71.0	Completely Full Window	Max OD	81.3
20%	61.9	45%	73.2		Max HT	44.4
25%	64.3	50%	76.0	Surface Area (mm ²)		
30%	65.8	60%	81.3	Unwound Core:	7,700	
35%	68.7	70%	87.1	40% Wound:	13,000	
					Coating Temp: (Continuous, up to; °C)	
					700 °C	
					200 °C	
Notes:						

