

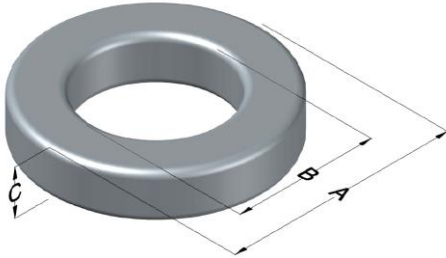

**0078171A7**

110 Delta Drive  
 Pittsburgh, PA 15238  
 NAFTA Sales: (1)800-245-3984  
 HK Sales : (852)3102-9337  
 magnetics@spang.com  
 www.mag-inc.com



XFLUX Permeability ( $\mu$ )	$A_L$ (nH/T <sup>2</sup> )	Core Marking			Coating Color
		Lot Number	Part Number	Inductance Grade	
26	80 ± 8%	XXXXXX	78171A7	N/A	Brown

Dimensions	Uncoated		Coated Limits			Packaging
	(mm)	(in)	(mm)	(in)		
OD (A)	165.10	6.500	166.50	6.555	max	Cardboard cut-outs Box Qty= 8 pcs
ID (B)	88.90	3.500	86.90	3.421	min	
HT (C)	25.40	1.000	27.30	1.075	max	

Electrical Characteristics			Physical Characteristics						
Watt Loss @ 50 kHz, 50mT typ (mW/cm <sup>3</sup> )	DC Bias typ (oersteds)		Voltage Breakdown wire to wire min (V <sub>AC</sub> )	Break Strength min (kg)	Window Area W <sub>A</sub> (mm <sup>2</sup> )	Cross Section A <sub>e</sub> (mm <sup>2</sup> )	Path Length L <sub>e</sub> (mm)	Volume V <sub>e</sub> (mm <sup>3</sup> )	Weight (g)
	250	80%							
	210	425	2000	136.0	5,930	948	386.5	366,700	2,280

Winding Information					Temperature Rating	
Winding Length Per Turn				Wound Coil Dimensions (mm)		Curie Temp: 500°C
Winding Factor	(mm)	Winding Factor	(mm)	40% Winding Factor		Coating Temp (Continuous up to): 200°C
				OD	193	Notes:
0%	135	40%	179	HT	53.7	
				Max OD	228	
20%	158	45%	187	Max HT	88.9	
25%	163	50%	193	Surface Area (mm <sup>2</sup> )		
30%	168	60%	206	Unwound Core	57,000	
35%	175	70%	222	40% Winding Factor	106,000	

**Typical DC Bias Performance**

