

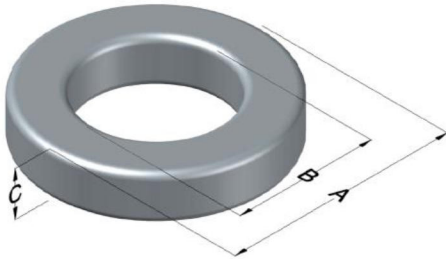

0078159A7

110 Delta Drive
 Pittsburgh, PA 15238
 NAFTA Sales: (1)800-245-3984
 HK Sales : (852)3102-9337
 magnetics@spang.com
 www.mag-inc.com



XFLUX Permeability (μ)	A_L (nH/T ²)	Core Marking			Coating Color
		Lot Number	Part Number	Inductance Grade	
75	139 \pm 8%	XXXXXX	78159A7	N/A	Brown

Dimensions	Uncoated		Coated Limits			Packaging
	(mm)	(in)	(mm)	(in)		
OD (A)	101.60	4.000	103.00	4.055	max	Cardboard cut-outs Box Qty= 25 pcs
ID (B)	57.15	2.250	55.75	2.195	min	
HT (C)	16.51	0.650	17.91	0.705	max	

Electrical Characteristics			Physical Characteristics						
Watt Loss @ 50 kHz, 100mT max(mW/cm ³)*	DC Bias min (oersteds)		Voltage Breakdown wire to wire min (V _{AC})	Break Strength min (kg)	Window Area W _A (mm ²)	Cross Section A _e (mm ²)	Path Length L _e (mm)	Volume V _e (mm ³)	Weight (g)
	80%	50%							
700	63	120	3000	181.0	2,470	358	243	86,900	630

Winding Information					Temperature Rating		
Winding Length Per Turn				Wound Coil Dimensions (mm)			Curie Temp: 700°C
Winding Factor	(mm)	Winding Factor	(mm)	40% Winding Factor		OD	112
				HT	34.9		
0%	82.2	40%	111	Completely Full Window		Max OD	136
20%	96.8	45%	116			Max HT	55.1
25%	100	50%	120	Surface Area (mm ²)			
30%	103	60%	128	Unwound Core		20,000	
35%	108	70%	139	40% Winding Factor		36,000	
Notes:							
Coating Temp (Continuous up to): 200°C							

