

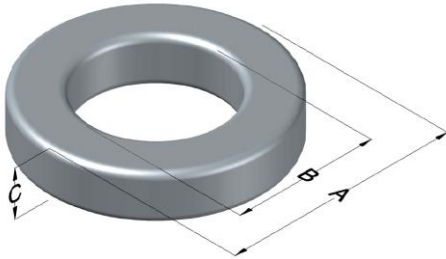

0078099A7

110 Delta Drive
 Pittsburgh, PA 15238
 NAFTA Sales: (1)800-245-3984
 HK Sales : (852)3102-9337
 magnetics@spang.com
 www.mag-inc.com



Kool M μ Permeability (μ)	A _L (nH/T ²)	Core Marking			Coating Color
		Lot Number	Part Number	Inductance Grade	
60	111 ± 8%	XXXXXX	78099A7	N/A	Brown

Dimensions	Uncoated		Coated Limits			Packaging
	(mm)	(in)	(mm)	(in)		
OD (A)	101.6	4.000	103.0	4.055	max	Cardboard cut-outs Box Qty= 25 pcs
ID (B)	57.20	2.252	55.75	2.195	min	
HT (C)	16.5	0.650	17.9	0.705	max	

Electrical Characteristics			Physical Characteristics						
Watt Loss @ 50 kHz, 100mT max(mW/cm ³)*	DC Bias min (oersteds)		Voltage Breakdown wire to wire min (V _{AC})	Break Strength min (kg)	Window Area W _A (mm ²)	Cross Section A _e (mm ²)	Path Length L _e (mm)	Volume V _e (mm ³)	Weight (g)
	80%	50%							
725	80.0	150	2000	181.0	2,470	358	243	86,900	620

Winding Information					Temperature Rating	
Winding Length Per Turn				Wound Coil Dimensions (mm)		Curie Temp: 700°C
Winding Factor	(mm)	Winding Factor	(mm)	40% Winding Factor		Coating Temp (Continuous up to): 200°C
				OD	112	Notes:
				HT	34.9	
				Completely Full Window		
				Max OD	136	
				Max HT		55.1
				Surface Area (mm ²)		
				Unwound Core		20,000
				40% Winding Factor		36,000

Typical DC Bias Performance

