

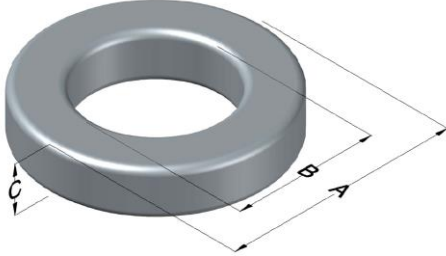

**0078068A7**

110 Delta Drive  
 Pittsburgh, PA 15238  
 NAFTA Sales: (1)800-245-3984  
 HK Sales : (852)3102-9337  
 magnetics@spang.com  
 www.mag-inc.com



XFlux Permeability ( $\mu$ )	$A_L$ (nH/T <sup>2</sup> )	Core Marking			Coating Color
		Lot Number	Part Number	Inductance Grade	
90	225 $\pm$ 8%	XXXXXX	78068A7	N/A	Brown

Dimensions	Uncoated		Coated Limits			Packaging
	(mm)	(in)	(mm)	(in)		
OD (A)	68.0	2.677	69.40	2.733	max	Cardboard cut-outs Box Qty= 35 pcs
ID (B)	36.0	1.417	34.69	1.365	min	
HT (C)	20.0	0.787	21.41	0.843	max	

Electrical Characteristics			Physical Characteristics						
Watt Loss @ 50 kHz, 100mT Max (mW/cm <sup>3</sup> )	DC Bias min (oersteds)		Voltage Breakdown wire to wire min (V <sub>AC</sub> )	Break Strength min (kg)	Window Area W <sub>A</sub> (mm <sup>2</sup> )	Cross Section A <sub>e</sub> (mm <sup>2</sup> )	Path Length L <sub>e</sub> (mm)	Volume V <sub>e</sub> (mm <sup>3</sup> )	Weight (g)
	80%	50%							
700	48.0	95	1000	181.0	945	314	158	49,700	380

Winding Information					Temperature Rating		
Winding Length Per Turn				Wound Coil Dimensions (mm)		Curie Temp: 700°C	
Winding Factor	(mm)	Winding Factor	(mm)	Maximum OD (70%)	89.2	Coating Temp (Continuous up to): 200°C	
				Maximum HT (70%)	45.4		
0%	77.7	40%	95.7	Surface Area (mm <sup>2</sup> )		Notes:	
20%	86.6	45%	97.9				
25%	89.0	50%	100.1	Unwound Core			12,700
30%	90.5	60%	106	40% Winding Factor			18,400
35%	93.4	70%	112				

