

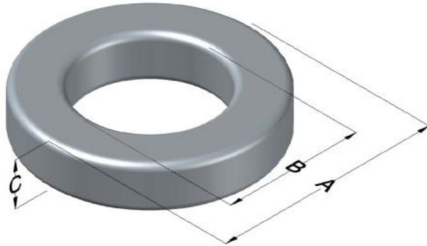

0077930A7HT19

110 Delta Drive
 Pittsburgh, PA 15238
 NAFTA Sales: (1)800-245-3984
 HK Sales : (852)3102-9337
 magnetics@spang.com
 www.mag-inc.com



Kool M μ Permeability (μ)	A _L (nH/T ²)	Core Marking			Coating Color
		Lot Number	Part Number	Inductance Grade	
125	253 ± 8%	XXXXXX	77930A7HT19	N/A	Black

Dimensions	Uncoated		Coated Limits			Packaging
	(mm)	(in)	(mm)	(in)		
OD (A)	26.92	1.060	27.69	1.090	max	Cardboard cut-outs Box Qty= 280 pcs
ID (B)	14.73	0.580	14.10	0.555	min	
HT (C)	18	0.709	19	0.748	max	

Electrical Characteristics			Physical Characteristics						
Watt Loss @ 100 kHz, 100mT max (mW/cm ³)	DC Bias min (oersteds)		Voltage Breakdown wire to wire min (V _{AC})	Break Strength min (kg)	Window Area W _A (mm ²)	Cross Section A _e (mm ²)	Path Length L _e (mm)	Volume V _e (mm ³)	Weight (g)
	80%	50%							
750	14	35	3000	77.0	156	105	63.5	6670	41

Winding Information					Temperature Rating	
Winding Length Per Turn				Wound Coil Dimensions (mm)		Curie Temp: 500°C
Winding Factor	(mm)	Winding Factor	(mm)	40% Winding Factor	OD	30.0
					HT	23.5
0%	51.6	40%	58.8	Completely Full Window	Max OD	37.3
20%	55.1	45%	59.8		Max HT	31.0
25%	56.0	50%	60.7	Surface Area (mm ²)		
30%	56.9	60%	62.9	Unwound Core	3,400	
35%	57.8	70%	65.4	40% Winding Factor	4,500	
Coating Temp (Continuous up to): 200°C						
Notes:						

