

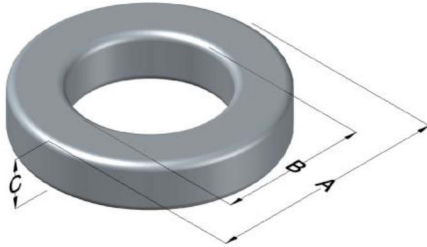

0077894A7HT29

110 Delta Drive
 Pittsburgh, PA 15238
 NAFTA Sales: (1)800-245-3984
 HK Sales : (852)3102-9337
 magnetics@spang.com
 www.mag-inc.com



Kool M μ Permeability (μ)	A _L (nH/T ²)	Core Marking			Coating Color
		Lot Number	Part Number	Inductance Grade	
60	187 ± 8%	XXXXXX	77894A7HT29	N/A	Black

Dimensions	Uncoated		Coated Limits			Packaging
	(mm)	(in)	(mm)	(in)		
OD (A)	26.92	1.060	27.69	1.090	max	Cardboard cut-outs Box Qty= 160 pcs
ID (B)	14.73	0.580	14.10	0.555	min	
HT (C)	27.94	1.100	29	1.141	max	

Electrical Characteristics			Physical Characteristics						
Watt Loss @ 100 kHz, 100mT max (mW/cm ³)	DC Bias min (oersteds)		Voltage Breakdown wire to wire min (V _{AC})	Break Strength min (kg)	Window Area W _A (mm ²)	Cross Section A _e (mm ²)	Path Length L _e (mm)	Volume V _e (mm ³)	Weight (g)
	80%	50%							
750	39	87	3000	77.0	156	164	63.5	10,400	60

Winding Information					Temperature Rating		
Winding Length Per Turn				Wound Coil Dimensions (mm)		Curie Temp: 500°C	
Winding Factor	(mm)	Winding Factor	(mm)	40% Winding Factor	OD	30.0	
					HT	33.5	
				Completely Full Window	Max OD	37.3	
					Max HT	41.0	
0%	71.6	40%	78.8	Surface Area (mm ²)			
20%	75.1	45%	79.8				
25%	76.0	50%	80.7	Unwound Core			
30%	76.9	60%	82.9	4,700			
35%	77.8	70%	85.4	40% Winding Factor			
				5,800			
Coating Temp (Continuous up to): 200°C							Notes:

Typical DC Bias Performance

