

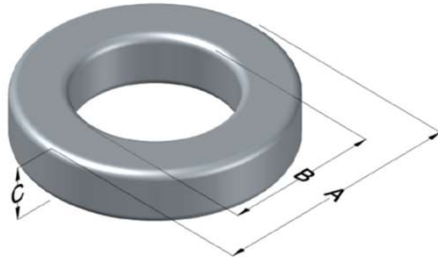

0077894A7HT23

110 Delta Drive
 Pittsburgh, PA 15238
 NAFTA Sales: (1)800-245-3984
 HK Sales : (852)3102-9337
 magnetics@spang.com
 www.mag-inc.com



Kool M μ Permeability (μ)	A _L (nH/T ²)	Core Marking			Coating Color
		Lot Number	Part Number	Inductance Grade	
60	150 ± 8%	XXXXXX	77894A7HT23	N/A	Black

Dimensions	Uncoated		Coated Limits			Packaging
	(mm)	(in)	(mm)	(in)		
OD (A)	26.92	1.060	27.69	1.090	max	Cardboard cut-outs Box Qty = 200 pcs
ID (B)	14.73	0.580	14.10	0.555	min	
HT (C)	21.99	0.866	23.00	0.906	max	

Electrical Characteristics			Physical Characteristics						
Watt Loss @ 100kHz, 100mT max (mW/cm ³)	DC Bias min (oersteds)		Voltage Breakdown wire to wire min (V _{AC})	Break Strength min (kg)	Window Area W _a (mm ²)	Cross Section A _e (mm ²)	Path Length L _e (mm)	Volume V _e (mm ³)	Est. Weight (g)
	750	80%							
	39	87	3000	77.0	156	131	63.5	8,320	46.7

Winding Information					Temperature Rating	
Winding Length Per Turn				Wound Coil Dimensions (mm)		Curie Temp: 500°C
Winding Factor	(mm)	Winding Factor	(mm)	40% Winding Factor	OD	30.9
					HT	27.8
0%	59.6	40%	66.9	Completely Full Window	Max OD	30.9
20%	63.2	45%	67.8		Max HT	32.6
25%	64.2	50%	69.0	Surface Area (mm ²)		
30%	64.9	60%	71.1	Unwound Core	3,900	
35%	65.9	70%	73.6	40% Winding Factor	4,900	
Coating Temp (Continuous up to): 200°C						
Notes:						

