

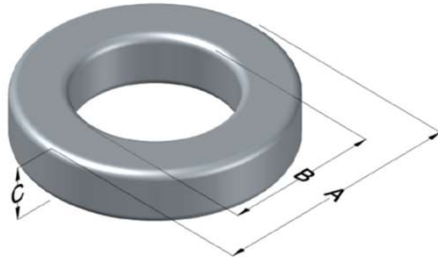

0077894A7HT19

110 Delta Drive
 Pittsburgh, PA 15238
 NAFTA Sales: (1)800-245-3984
 HK Sales : (852)3102-9337
 magnetics@spang.com
 www.mag-inc.com



| Kool M μ Permeability (μ) | A _L (nH/T ²) | Core Marking | | | Coating Color |
|---|--|---------------|----------------|---------------------|------------------|
| | | Lot Number | Part Number | Inductance Grade | |
| 60 | 120 ± 8% | XXXXXX | 77894A7HT19 | N/A | Black |

| Dimensions | Uncoated | | Coated Limits | | | Packaging |
|------------|----------|-------|---------------|-------|-----|---|
| | (mm) | (in) | (mm) | (in) | | |
| OD (A) | 26.92 | 1.060 | 27.69 | 1.090 | max | Cardboard cut-outs Box Qty = 280 pcs |
| ID (B) | 14.73 | 0.580 | 14.10 | 0.555 | min | |
| HT (C) | 17.99 | 0.708 | 19.00 | 0.748 | max | |

| Electrical Characteristics | | | Physical Characteristics | | | | | | |
|---|---------------------------|-----|--|-------------------------------|---|---|---------------------------------------|---|-----------------------|
| Watt Loss @ 100kHz, 100mT max (mW/cm ³) | DC Bias min (oersteds) | | Voltage Breakdown wire to wire min (V _{AC}) | Break Strength min (kg) | Window Area W _a (mm ²) | Cross Section A _e (mm ²) | Path Length L _e (mm) | Volume V _e (mm ³) | Est. Weight (g) |
| | 80% | 50% | | | | | | | |
| 750 | 39 | 87 | 3000 | 77.0 | 156 | 105 | 63.5 | 6,670 | 38.1 |

| Winding Information | | | | | Temperature Rating | |
|--|------|-------------------|------|---------------------------------|--------------------|-------------------|
| Winding Length Per Turn | | | | Wound Coil Dimensions (mm) | | Curie Temp: 500°C |
| Winding Factor | (mm) | Winding Factor | (mm) | 40% Winding Factor | OD | 30.9 |
| | | | | | HT | 23.8 |
| 0% | 51.6 | 40% | 58.9 | Completely Full Window | Max OD | 30.9 |
| 20% | 55.2 | 45% | 59.8 | | Max HT | 28.6 |
| 25% | 56.2 | 50% | 61.0 | Surface Area (mm ²) | | |
| 30% | 56.9 | 60% | 63.1 | Unwound Core | | 3,400 |
| 35% | 57.9 | 70% | 65.6 | 40% Winding Factor | | 4,400 |
| Notes: | | | | | | |
| Coating Temp (Continuous up to): 200°C | | | | | | |

