

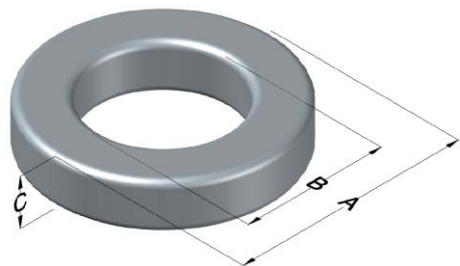

0077726A7

110 Delta Drive
 Pittsburgh, PA 15238
 NAFTA Sales: (1)800-245-3984
 HK Sales : (852)3102-9337
 magnetics@spang.com
 www.mag-inc.com



Kool M μ Permeability (μ)	A _L (nH/T ²)	Core Marking			Coating Color
		Lot Number	Part Number	Inductance Grade	
60	175 \pm 8%	XXXXXX	77726A7	N/A	Black

Dimensions					Packaging
Uncoated			Coated Limits		
	(mm)	(in)	(mm)	(in)	
OD (A)	50.55	1.990	51.51	2.028	Cardboard cut-outs Box Qty = 70 Pcs
ID (B)	24.77	0.975	24.00	0.945	
HT (C)	20.83	0.820	21.59	0.850	

Electrical Characteristics			Physical Characteristics						
Watt Loss @ 100kHz, 100mT (max, mW/cm ³)	DC Bias min (Oersteds)		Voltage Breakdown wire-to-wire min (V _{AC})	Break Strength (min, kg)	Window Area, W _A (mm ²)	Cross Section, A _e (mm ²)	Path Length, L _e (mm)	Volume V _e (mm ³)	Weight (g)
	80%	50%							
750	39	87	2000	95.2	452	262	113.5	29700	188.2

Winding Information					Temperature Rating	
Winding Length per Turn			Wound Coil Dimensions (mm)		Curie Temp (°C):	
Winding Factor	(mm)	Winding Factor	(mm)	40% Winding Factor	OD	500 °C
0%	131.0	40%	143.0	Completely Full Window	64.0	Coating Temp: (Continuous, up to; °C)
20%	137.0	45%	145.0		HT	
25%	138.0	50%	147.0	Surface Area (mm ²)	Max OD	200 °C
30%	140.0	60%	150.0		Max HT	
35%	142.0	70%	155.0	Unwound Core:	23,310	Notes:
				40% Wound:	33,600	

