

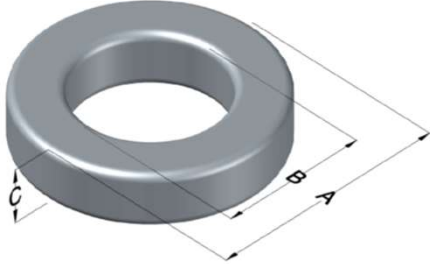

**0077600A7**

110 Delta Drive  
 Pittsburgh, PA 15238  
 NAFTA Sales: (1)800-245-3984  
 HK Sales : (852)3102-9337  
 magnetics@spang.com



Kool M $\mu$ Permeability ( $\mu$ )	A <sub>L</sub> (nH/T <sup>2</sup> )	Core Marking			Coating Color
		Lot Number	Part Number	Inductance Grade	
40	83 ± 8%	XXXXXX	77600A7	N/A	Black

Dimensions	Uncoated		Coated Limits			Packaging
	(mm)	(in)	(mm)	(in)		
OD (A)	59.60	2.346	60.60	2.385	max	Cardboard cut-outs Box Qty= 63 pcs
ID (B)	34.00	1.338	33.00	1.299	min	
HT (C)	19.50	0.767	20.50	0.807	max	

Electrical Characteristics			Physical Characteristics						
Watt Loss @ 100kHz, 100mT max (mW/cm <sup>3</sup> )	DC Bias min (oersteds)		Voltage Breakdown wire to wire min (V <sub>AC</sub> )	Break Strength min (kg)	Window Area W <sub>a</sub> (mm <sup>2</sup> )	Cross Section A <sub>e</sub> (mm <sup>2</sup> )	Path Length L <sub>e</sub> (mm)	Volume V <sub>e</sub> (mm <sup>3</sup> )	Est. Weight (g)
	80%	50%							
900	58.5	133	3000	154	855	237	143	33,900	185

Winding Information					Temperature Rating	
Winding Length Per Turn				Wound Coil Dimensions (mm)		Curie Temp: 500°C
Winding Factor	(mm)	Winding Factor	(mm)	40% Winding Factor	OD	Coating Temp (Continuous up to): 200°C
					HT	
0%	68.6	40%	85.5	Completely Full Window	Max OD	Notes:
20%	77.3	45%	88.2		Max HT	
25%	79.2	50%	90.5	Surface Area (mm <sup>2</sup> )		
30%	81.2	60%	95.8	Unwound Core	10,000	
35%	83.6	70%	102	40% Winding Factor	15,000	

