

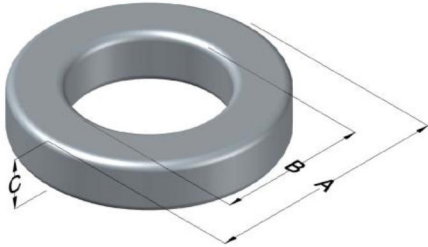

**0077555A7**

110 Delta Drive  
 Pittsburgh, PA 15238  
 NAFTA Sales: (1)800-245-3984  
 HK Sales : (852)3102-9337  
 magnetics@spang.com  
 www.mag-inc.com



Kool M $\mu$ Permeability ( $\mu$ )	A <sub>L</sub> (nH/T <sup>2</sup> )	Core Marking			Coating Color
		Lot Number	Part Number	Inductance Grade	
40	41 ± 8%	XXXXXX	77555A7	N/A	Black

Dimensions	Uncoated		Coated Limits			Packaging
	(mm)	(in)	(mm)	(in)		
OD (A)	32.79	1.291	33.66	1.325	max	Cardboard cut-outs Box Qty= 250 pcs
ID (B)	20.09	0.791	19.46	0.766	min	
HT (C)	10.67	0.420	11.43	0.450	max	

Electrical Characteristics			Physical Characteristics						
Watt Loss @ 100 kHz, 100mT max (mW/cm <sup>3</sup> )	DC Bias min (oersteds)		Voltage Breakdown wire to wire min (V <sub>AC</sub> )	Break Strength min (kg)	Window Area W <sub>A</sub> (mm <sup>2</sup> )	Cross Section A <sub>e</sub> (mm <sup>2</sup> )	Path Length L <sub>e</sub> (mm)	Volume V <sub>e</sub> (mm <sup>3</sup> )	Weight (g)
	900	80%							
	58.5	133							

Winding Information					Temperature Rating				
Winding Length Per Turn				Wound Coil Dimensions (mm)			Curie Temp: 500°C		
Winding Factor	(mm)	Winding Factor	(mm)	40% Winding Factor	OD	36.8			
					HT	17.8			
0%	37.1	40%	46.9	Completely Full Window	Max OD	46.7			
					Max HT	28.0			
20%	42.1	45%	48.5	Surface Area (mm <sup>2</sup> )					
25%	43.2	50%	50.0						
30%	44.4	60%	52.8						
35%	45.9	70%	56.3	Unwound Core	3,100				
				40% Winding Factor	4,900				
								Coating Temp (Continuous up to): 200°C	
								Notes:	

**Typical DC Bias Performance**

