

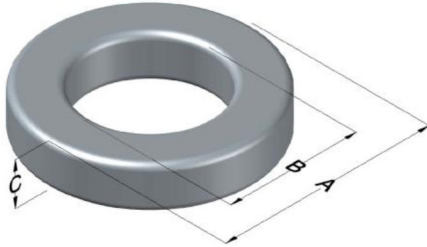

0077548A7HT33

110 Delta Drive
 Pittsburgh, PA 15238
 NAFTA Sales: (1)800-245-3984
 HK Sales : (852)3102-9337
 magnetics@spang.com
 www.mag-inc.com



Kool M μ Permeability (μ)	A _L (nH/T ²)	Core Marking			Coating Color
		Lot Number	Part Number	Inductance Grade	
125	381 ± 8%	XXXXXX	77548A7HT33	N/A	Black

Dimensions	Uncoated		Coated Limits			Packaging
	(mm)	(in)	(mm)	(in)		
OD (A)	32.79	1.291	33.66	1.325	max	Cardboard cut-outs Box Qty= 75 pcs
ID (B)	20.09	0.791	19.46	0.766	min	
HT (C)	32	1.260	33	1.290	max	

Electrical Characteristics			Physical Characteristics						
Watt Loss @ 100 kHz, 100mT max (mW/cm ³)	DC Bias min (oersteds)		Voltage Breakdown wire to wire min (V _{AC})	Break Strength min (kg)	Window Area W _A (mm ²)	Cross Section A _e (mm ²)	Path Length L _e (mm)	Volume V _e (mm ³)	Weight (g)
	750	80% 14							

Winding Information					Temperature Rating				
Winding Length Per Turn				Wound Coil Dimensions (mm)			Curie Temp: 500°C		
Winding Factor	(mm)	Winding Factor	(mm)	40% Winding Factor	OD	36.8			
					HT	39.3			
0%	80.3	40%	90.2	Completely Full Window	Max OD	46.7			
					Max HT	49.5			
20%	85.2	45%	91.5	Surface Area (mm ²)					
25%	86.3	50%	92.9						
30%	87.6	60%	96.0						
35%	88.8	70%	99.4	Unwound Core	6,700				
				40% Winding Factor	8,600				
								Coating Temp (Continuous up to): 200°C	
								Notes:	

