

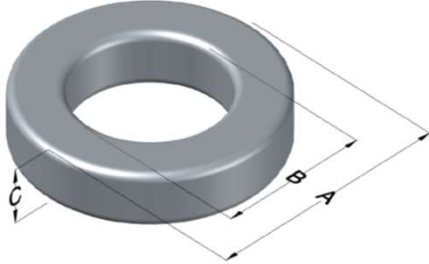

0077515A7

110 Delta Drive
 Pittsburgh, PA 15238
 NAFTA Sales: (1)800-245-3984
 HK Sales : (852)3102-9337
 magnetics@spang.com



Kool M μ Permeability (μ)	A _L (nH/T ²)	Core Marking			Coating Color
		Lot Number	Part Number	Inductance Grade	
26	65 ± 8%	XXXXXX	77515A7	N/A	Black

Dimensions	Uncoated		Coated Limits			Packaging
	(mm)	(in)	(mm)	(in)		
OD (A)	52.10	2.051	53.00	2.087	max	Cardboard cut-outs Box Qty= 80 pcs
ID (B)	21.50	0.846	20.60	0.811	min	
HT (C)	15.20	0.598	16.10	0.634	max	

Electrical Characteristics			Physical Characteristics						
Watt Loss @ 100kHz, 100mT max (mW/cm ³)	DC Bias min (oersteds)		Voltage Breakdown wire to wire min (V _{AC})	Break Strength min (kg)	Window Area W _a (mm ²)	Cross Section A _e (mm ²)	Path Length L _e (mm)	Volume V _e (mm ³)	Est. Weight (g)
	80%	50%							
900	95	205	3000	136.0	333	217	109	23,500	127

Winding Information					Temperature Rating	
Winding Length Per Turn				Wound Coil Dimensions (mm)		Curie Temp: 500°C
Winding Factor	(mm)	Winding Factor	(mm)	40% Winding Factor		Coating Temp (Continuous up to): 200°C
				OD	55.2	
				HT	22.7	Notes:
				Max OD	57.4	
				Max HT	31.5	
0%	64.6	40%	75.3	Completely Full Window		
20%	70.0	45%	76.8	Surface Area (mm ²)		
25%	71.3	50%	78.3			
30%	72.3	60%	81.5	Unwound Core	7,500	
35%	74.0	70%	85.2	40% Winding Factor	9,400	

