

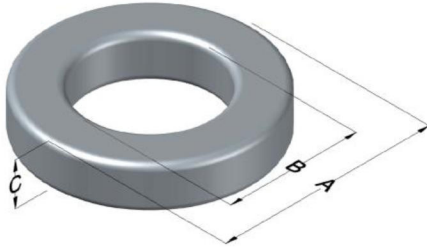

**0077454A7**

110 Delta Drive  
 Pittsburgh, PA 15238  
 NAFTA Sales: (1)800-245-3984  
 HK Sales : (852)3102-9337  
 magnetics@spang.com  
 www.mag-inc.com



| Kool M $\mu$<br>Permeability<br>( $\mu$ ) | A <sub>L</sub><br>(nH/T <sup>2</sup> ) | Core Marking  |                |                     | Coating<br>Color |
|---|--|---------------|----------------|---------------------|------------------|
|   |  | Lot<br>Number | Part<br>Number | Inductance<br>Grade |                  |
| 125                                       | 224 ± 8%                               | XXXXXX        | 77454A7        | N/A                 | Black            |

| Dimensions | Uncoated |       | Coated Limits |       |     | Packaging                              |
|------------|----------|-------|---------------|-------|-----|--|
|            | (mm)     | (in)  | (mm)          | (in)  |     |  |
| OD (A)     | 42.90    | 1.689 | 43.84         | 1.726 | max | Cardboard cut-outs<br>Box Qty= 120 pcs |
| ID (B)     | 24.21    | 0.953 | 23.39         | 0.921 | min |  |
| HT (C)     | 16.26    | 0.640 | 17.27         | 0.680 | max |  |

| Electrical Characteristics                                 |                           |     | Physical Characteristics                                       |                               |   |   |                                       |   |               |
|--|---------------------------|-----|--|-------------------------------|---|---|---------------------------------------|---|---------------|
| Watt Loss<br>@ 100 kHz, 100mT<br>max (mW/cm <sup>3</sup> ) | DC Bias<br>min (oersteds) |     | Voltage<br>Breakdown<br>wire to wire<br>min (V <sub>AC</sub> ) | Break<br>Strength<br>min (kg) | Window<br>Area<br>W <sub>A</sub> (mm <sup>2</sup> ) | Cross<br>Section<br>A <sub>e</sub> (mm <sup>2</sup> ) | Path<br>Length<br>L <sub>e</sub> (mm) | Volume<br>V <sub>e</sub> (mm <sup>3</sup> ) | Weight<br>(g) |
|  | 750                       | 80% |  |                               |   |   |                                       |   |               |
|  | 14                        | 35  | 3000   | 98.8                          | 430   | 147.5   | 102                                   | 15100                                       | 90.1          |

| Winding Information                    |      |                   |      |                                 | Temperature Rating |                   |
|--|------|-------------------|------|---------------------------------|--------------------|-------------------|
| Winding Length Per Turn                |      |                   |      | Wound Coil Dimensions (mm)      |                    | Curie Temp: 500°C |
| Winding<br>Factor                      | (mm) | Winding<br>Factor | (mm) | 40% Winding Factor              | OD                 | 47.6              |
|  |      |                   |      |                                 | HT                 | 24.6              |
| 0%                                     | 55.0 | 40%               | 67.1 | Completely Full Window          | Max OD             | 59.4              |
| 20%                                    | 61.1 | 45%               | 68.9 |                                 | Max HT             | 36.7              |
| 25%                                    | 62.5 | 50%               | 70.8 | Surface Area (mm <sup>2</sup> ) |                    |                   |
| 30%                                    | 63.8 | 60%               | 74.2 | Unwound Core                    |                    | 5,800             |
| 35%                                    | 65.6 | 70%               | 78.5 | 40% Winding Factor              |                    | 8,400             |
| Coating Temp (Continuous up to): 200°C |      |                   |      |                                 |                    |                   |
| Notes:                                 |      |                   |      |                                 |                    |                   |

