

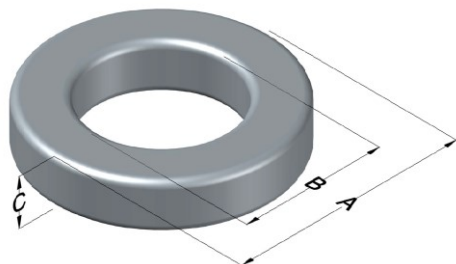

0077450A7

110 Delta Drive
 Pittsburgh, PA 15238
 NAFTA Sales: (1)800-245-3984
 HK Sales : (852)3102-9337
 magnetics@spang.com
 www.mag-inc.com



Kool M μ Permeability (μ)	A _L (nH/T ²)	Core Marking			Coating Color
		Lot Number	Part Number	Inductance Grade	
40	72 \pm 8%	XXXXXX	77450A7	N/A	Black

Dimensions					Packaging	
Uncoated		Coated Limits				
	(mm)	(in)	(mm)	(in)	Cardboard cut-outs Box Qty = 120 Pcs	
OD (A)	42.90	1.689	43.83	1.724		max
ID (B)	24.20	0.953	23.40	0.921		min
HT (C)	16.26	0.640	17.26	0.675		max

Electrical Characteristics			Physical Characteristics						
Watt Loss @ 100kHz, 100mT (max, mW/cm ³)	DC Bias min (Oersteds)		Voltage Breakdown wire-to-wire min (V _{AC})	Break Strength (min, kg)	Window Area, W _A (mm ²)	Cross Section, A _e (mm ²)	Path Length, L _e (mm)	Volume V _e (mm ³)	Weight (g)
	80%	50%							
900	59	133	2000	98.8	430	147.5	102	15100	84.3

Winding Information					Temperature Rating	
Winding Length per Turn			Wound Coil Dimensions (mm)		Curie Temp (°C):	
Winding Factor	(mm)	Winding Factor	(mm)	40% Winding Factor	OD	500 °C
0%	55.0	40%	67.1	Completely Full Window	HT	Coating Temp: (Continuous, up to; °C)
20%	61.1	45%	68.9		Max OD	
25%	62.5	50%	70.8	Max HT	23.9	Notes:
30%	63.8	60%	74.2	Surface Area (mm ²)		
35%	65.6	70%	78.5	Unwound Core:	5800	
				40% Wound:	8400	

