

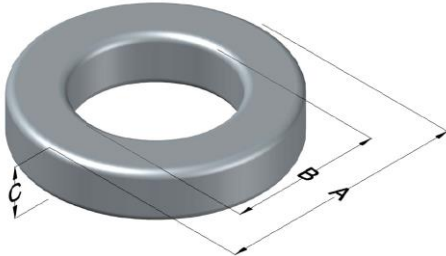

0077350A7HT19

110 Delta Drive
 Pittsburgh, PA 15238
 NAFTA Sales: (1)800-245-3984
 HK Sales : (852)3102-9337
 magnetics@spang.com
 www.mag-inc.com



Kool M μ Permeability (μ)	A _L (nH/T ²)	Core Marking			Coating Color
		Lot Number	Part Number	Inductance Grade	
125	210 ± 8%	XXXXXX	77350A7HT19	N/A	Black

Dimensions	Uncoated		Coated Limits			Packaging
	(mm)	(in)	(mm)	(in)		
OD (A)	23.6	0.928	24.4	0.958	max	Cardboard cut-outs Box Qty= TBD
ID (B)	14.4	0.567	13.7	0.542	min	
HT (C)	17.8	0.700	19.0	0.748	max	

Electrical Characteristics			Physical Characteristics						
Watt Loss @ 100 kHz, 100mT max(mW/cm ³)	DC Bias min (oersteds)		Voltage Breakdown wire to wire min (V _{AC})	Break Strength min (kg)	Window Area W _A (mm ²)	Cross Section A _e (mm ²)	Path Length L _e (mm)	Volume V _e (mm ³)	Weight (g)
	1000	80%							
	13.5	35.0							

Winding Information					Temperature Rating	
Winding Length Per Turn				Wound Coil Dimensions (mm)		Curie Temp: 500°C
Winding Factor	(mm)	Winding Factor	(mm)	40% Winding Factor		Coating Temp (Continuous up to): 200°C
				OD	26.7	
				HT	23.5	Notes:
				Completely Full Window		
				Max OD	33.5	
0%	48.7	40%	55.8	Max HT	30.7	
20%	52.2	45%	56.7	Surface Area (mm ²)		
25%	53.0	50%	57.7	Unwound Core		2,900
30%	53.9	60%	59.9	40% Winding Factor		3,900
35%	54.8	70%	62.3			

