

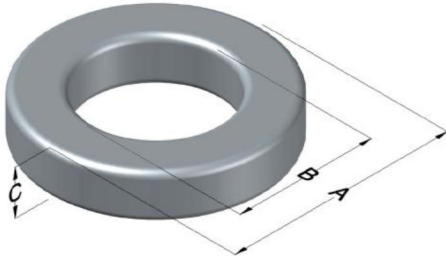

**0077192A7HT21**

110 Delta Drive  
 Pittsburgh, PA 15238  
 NAFTA Sales: (1)800-245-3984  
 HK Sales : (852)3102-9337  
 magnetics@spang.com  
 www.mag-inc.com



Kool M $\mu$ Permeability ( $\mu$ )	A <sub>L</sub> (nH/T <sup>2</sup> )	Core Marking			Coating Color
		Lot Number	Part Number	Inductance Grade	
60	182 ± 8%	XXXXXX	77192A7HT21	N/A	Black

Dimensions	Uncoated		Coated Limits		Packaging
	(mm)	(in)	(mm)	(in)	
OD (A)	57.15	2.250	58.04	2.285	Cardboard cut-outs Box Qty= TBD
ID (B)	26.39	1.039	25.58	1.007	
HT (C)	20.1	0.791	21.0	0.826	

Electrical Characteristics			Physical Characteristics						
Watt Loss @ 100 kHz, 100mT max(mW/cm <sup>3</sup> )	DC Bias min (A-T/cm)		Voltage Breakdown wire to wire min (V <sub>AC</sub> )	Break Strength min (kg)	Window Area W <sub>A</sub> (mm <sup>2</sup> )	Cross Section A <sub>e</sub> (mm <sup>2</sup> )	Path Length L <sub>e</sub> (mm)	Volume V <sub>e</sub> (mm <sup>3</sup> )	Weight (g)
	900	80%							
	39.0	87.0							

Winding Information					Temperature Rating	
Winding Length Per Turn				Wound Coil Dimensions (mm)		Curie Temp: 500°C
Winding Factor	(mm)	Winding Factor	(mm)	40% Winding Factor		Coating Temp (Continuous up to): 200°C
				OD	62.0	
				HT	28.8	Notes:
				Completely Full Window		
				Max OD	75.7	
0%	74.5	40%	87.5	Max HT	38.8	
20%	80.8	45%	89.4	Surface Area (mm <sup>2</sup> )		
25%	82.5	50%	91.2	Unwound Core		9,800
30%	84.1	60%	95.3	40% Winding Factor		14,000
35%	85.9	70%	99.8			

