

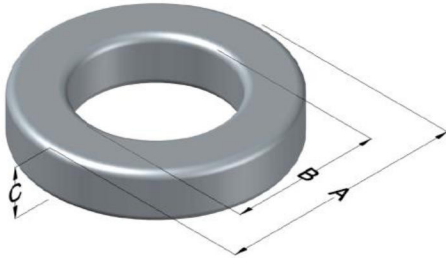

0077184AY

110 Delta Drive
 Pittsburgh, PA 15238
 NAFTA Sales: (1)800-245-3984
 HK Sales : (852)3102-9337
 magnetics@spang.com
 www.mag-inc.com



Kool M μ Permeability (μ)	A _L (nH/T ²)	Core Marking			Coating Color
		Lot Number	Part Number	Inductance Grade	
90	30 ± 15%	N/A	N/A	N/A	Clear

Dimensions	Uncoated		Coated Limits			Packaging
	(mm)	(in)	(mm)	(in)		
OD (A)	4.65	0.183	5.10	0.201	max	Bulk Pack 10 vials/box Box Qty= 5000 pcs
ID (B)	2.36	0.093	2.03	0.080	min	
HT (C)	2.54	0.100	3.00	0.118	max	

Electrical Characteristics			Physical Characteristics						
Watt Loss @ 100 kHz, 100mT max(mW/cm ³)	DC Bias min (oersteds)		Voltage Breakdown wire to wire min (V _{AC})	Break Strength min (kg)	Window Area W _A (mm ²)	Cross Section A _e (mm ²)	Path Length L _e (mm)	Volume V _e (mm ³)	Weight (g)
	750	80%							
	21.0	52.0							

Winding Information					Temperature Rating	
Winding Length Per Turn				Wound Coil Dimensions (mm)		Curie Temp: 500°C
Winding Factor	(mm)	Winding Factor	(mm)	40% Winding Factor	OD	5.56
					HT	3.73
0%	9.79	40%	10.7	Completely Full Window	Max OD	6.65
20%	10.3	45%	10.9		Max HT	4.94
25%	10.4	50%	11.0	Surface Area (mm ²)		
30%	10.5	60%	11.3	Unwound Core		110
35%	10.6	70%	11.6	40% Winding Factor		130
Notes: Parylene coated, color appears clear to milky white.						

