

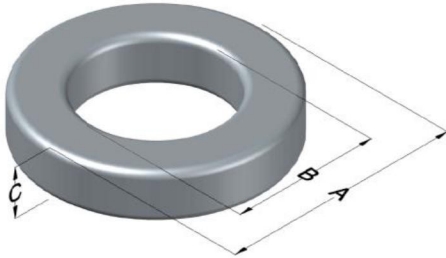

0078170A7

110 Delta Drive
 Pittsburgh, PA 15238
 NAFTA Sales: (1)800-245-3984
 HK Sales : (852)3102-9337
 magnetics@spang.com
 www.mag-inc.com



XFLUX Permeability (μ)	A_L (nH/T ²)	Core Marking			Coating Color
		Lot Number	Part Number	Inductance Grade	
19	58 ± 8%	XXXXXX	78170A7	N/A	Brown

Dimensions	Uncoated		Coated Limits			Packaging
	(mm)	(in)	(mm)	(in)		
OD (A)	165.10	6.500	166.50	6.555	max	Cardboard cut-outs Box Qty= 8 pcs
ID (B)	88.90	3.500	86.90	3.421	min	
HT (C)	25.40	1.000	27.30	1.075	max	

Electrical Characteristics			Physical Characteristics						
Watt Loss @ 50 kHz, 50mT max (mW/cm ³)	DC Bias min (oersteds)		Voltage Breakdown wire to wire min (V _{AC})	Break Strength min (kg)	Window Area W _A (mm ²)	Cross Section A _e (mm ²)	Path Length L _e (mm)	Volume V _e (mm ³)	Weight (g)
	80%	50%							
230	290	565	2000	136.0	5,930	948	387	366,700	2,280

Winding Information					Temperature Rating	
Winding Length Per Turn				Wound Coil Dimensions (mm)		Curie Temp: 500°C
Winding Factor	(mm)	Winding Factor	(mm)	40% Winding Factor		Coating Temp (Continuous up to): 200°C
				OD	181	Notes:
0%	135	40%	179	HT	56.3	
				Max OD	225	
20%	158	45%	187	Max HT	103	
25%	163	50%	193	Surface Area (mm ²)		
30%	168	60%	206	Unwound Core	57,000	
35%	175	70%	222	40% Winding Factor	96,000	

