

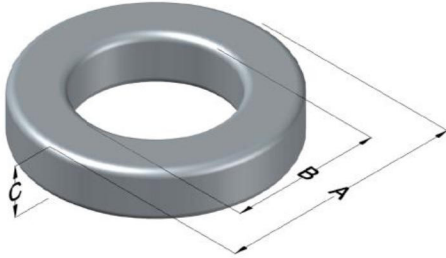

**0077070A7**

110 Delta Drive  
 Pittsburgh, PA 15238  
 NAFTA Sales: (1)800-245-3984  
 HK Sales : (852)3102-9337  
 magnetics@spang.com  
 www.mag-inc.com



Kool M $\mu$ Permeability ( $\mu$ )	A <sub>L</sub> (nH/T <sup>2</sup> )	Core Marking			Coating Color
		Lot Number	Part Number	Inductance Grade	
125	312 ± 8%	XXXXXX	77070A7	N/A	Black

Dimensions	Uncoated		Coated Limits		Packaging
	(mm)	(in)	(mm)	(in)	
OD (A)	68.00	2.677	69.42	2.733	Cardboard cut-outs Box Qty= 35 pcs
ID (B)	35.99	1.417	34.67	1.365	
HT (C)	19.99	0.787	21.41	0.843	

Electrical Characteristics			Physical Characteristics						
Watt Loss @ 100 kHz, 100mT max (mW/cm <sup>3</sup> )	DC Bias min (oersteds)		Voltage Breakdown wire to wire min (V <sub>AC</sub> )	Break Strength min (kg)	Window Area W <sub>A</sub> (mm <sup>2</sup> )	Cross Section A <sub>e</sub> (mm <sup>2</sup> )	Path Length L <sub>e</sub> (mm)	Volume V <sub>e</sub> (mm <sup>3</sup> )	Weight (g)
	750	80%							
	14	35	3000	181.0	945	314	158	49,700	308

Winding Information						Temperature Rating			
Winding Length Per Turn				Wound Coil Dimensions (mm)		Curie Temp: 500°C			
Winding Factor	(mm)	Winding Factor	(mm)	40% Winding Factor	OD	74.7			
					HT	37.4			
0%	77.6	40%	95.1	Completely Full Window	Max OD	92.7			
					Max HT	50.6			
20%	86.6	45%	98.0	Surface Area (mm <sup>2</sup> )					
25%	88.6	50%	101						
30%	90.7	60%	106						
35%	93.2	70%	112	Unwound Core		12,700			
				40% Winding Factor		19,000			
								Notes:	
								Coating Temp (Continuous up to): 200°C	

**Typical DC Bias Performance**

