

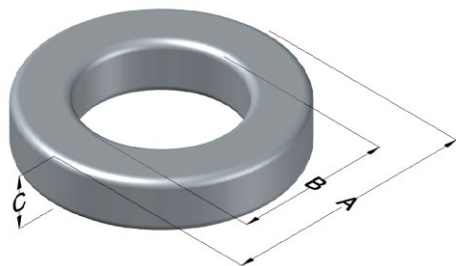

0076932A7

110 Delta Drive
 Pittsburgh, PA 15238
 NAFTA Sales: (1)800-245-3984
 HK Sales : (852)3102-9337
 magnetics@spang.com
 www.mag-inc.com



Kool M μ Hf Permeability (μ)	A _L (nH/T ²)	Core Marking			Coating Color
		Lot Number	Part Number	Inductance Grade	
26	32 ± 8%	XXXXXX	76932A7	N/A	Black

Dimensions					Packaging	
Uncoated			Coated Limits			
	(mm)	(in)	(mm)	(in)		
OD (A)	26.92	1.060	27.69	1.090	max	Cardboard cut-outs Box Qty = 400 Pcs
ID (B)	14.73	0.580	14.10	0.555	min	
HT (C)	11.18	0.440	11.94	0.470	max	

Electrical Characteristics			Physical Characteristics						
Watt Loss @ 100kHz, 100mT (max, mW/cm ³)	DC Bias min (Oersteds)		Voltage Breakdown wire-to-wire min (V _{AC})	Break Strength (min, kg)	Window Area, W _A (mm ²)	Cross Section, A _e (mm ²)	Path Length, L _e (mm)	Volume V _e (mm ³)	Weight (g)
	80%	50%							
625	130	245	2000	76.6	156	65.4	63.5	4150	24.4

Winding Information					Temperature Rating		
Winding Length per Turn			Wound Coil Dimensions (mm)			Curie Temp (°C):	500 °C
Winding Factor	(mm)	Winding Factor	(mm)	40% Winding Factor	OD	HT	Coating Temp: (Continuous, up to; °C)
0%	37.5	40%	44.6	Completely Full Window	Max OD	37.3	Notes:
20%	41.1	45%	45.7		Max HT	24.0	
25%	41.9	50%	46.6	Surface Area (mm ²)			
30%	42.8	60%	48.8	Unwound Core:	2400		
35%	43.8	70%	51.3	40% Wound:	3500		

