

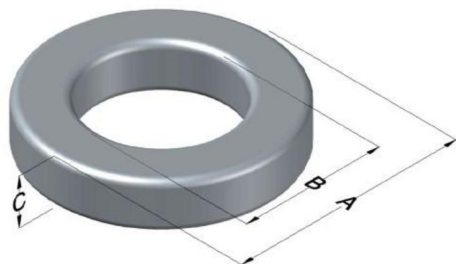

0076591A7

110 Delta Drive
 Pittsburgh, PA 15238
 NAFTA Sales: (1)800-245-3984
 HK Sales : (852)3102-9337
 magnetics@spang.com
 www.mag-inc.com



Kool M μ Hf Permeability (μ)	A _L (nH/T ²)	Core Marking			Coating Color
		Lot Number	Part Number	Inductance Grade	
40	25 \pm 8%	XXXXXX	76591A7	N/A	Black

Dimensions						Packaging
Uncoated			Coated Limits			
	(mm)	(in)	(mm)	(in)		Cardboard cut-outs Box Qty = 300 Pcs
OD (A)	34.29	1.350	35.18	1.385	max	
ID (B)	23.37	0.920	22.56	0.888	min	
HT (C)	8.89	0.350	9.78	0.385	max	

Electrical Characteristics			Physical Characteristics						
Watt Loss @ 100kHz, 100mT (max, mW/cm ³)	DC Bias min (Oersteds)		Voltage Breakdown wire-to-wire min (V _{AC})	Break Strength (min, kg)	Window Area, W _A (mm ²)	Cross Section, A _e (mm ²)	Path Length, L _e (mm)	Volume V _e (mm ³)	Weight (g)
	80%	50%							
500	75.0	145	3000	53.5	399	46.4	89.5	4150	33

Winding Information					Temperature Rating	
Winding Length per Turn			Wound Coil Dimensions (mm)		Curie Temp (°C):	500 °C
Winding Factor	(mm)	Winding Factor	(mm)	40% Winding Factor	OD	40.5
0%	32.2	40%	44.0	Completely Full Window	HT	16.8
20%	38.1	45%	45.6		Max OD	50.1
25%	39.6	50%	47.3	Surface Area (mm ²)	Max HT	29.0
30%	40.6	60%	50.8		Unwound Core:	2900
35%	42.5	70%	54.9		40% Wound:	5500

