

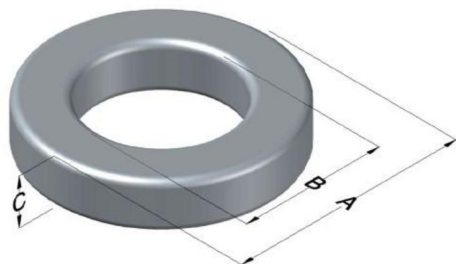

0076555A7

110 Delta Drive
 Pittsburgh, PA 15238
 NAFTA Sales: (1)800-245-3984
 HK Sales : (852)3102-9337
 magnetics@spang.com
 www.mag-inc.com



Kool M μ Hf Permeability (μ)	A_L (nH/T ²)	Core Marking			Coating Color
		Lot Number	Part Number	Inductance Grade	
40	41 \pm 8%	XXXXXX	76555A7	N/A	Black

Dimensions					Packaging
Uncoated		Coated Limits			
	(mm)	(in)	(mm)	(in)	
OD (A)	32.79	1.291	33.66	1.325	max
ID (B)	20.09	0.791	19.46	0.766	min
HT (C)	10.67	0.420	11.43	0.450	max

Cardboard cut-outs
Box Qty = 250 Pcs

Electrical Characteristics			Physical Characteristics						
Watt Loss @ 100kHz, 100mT (max, mW/cm ³)	DC Bias min (Oersteds)		Voltage Breakdown wire-to-wire min (V _{AC})	Break Strength (min, kg)	Window Area, W _A (mm ²)	Cross Section, A _e (mm ²)	Path Length, L _e (mm)	Volume V _e (mm ³)	Weight (g)
	80%	50%							
500	75.0	145	3000	78.9	297	65.6	81.4	5340	40

Winding Information					Temperature Rating	
Winding Length per Turn			Wound Coil Dimensions (mm)		Curie Temp (°C):	500 °C
Winding Factor	(mm)	Winding Factor	(mm)	40% Winding Factor	OD	36.8
0%	37.1	40%	46.9	Completely Full Window	HT	17.8
20%	42.1	45%	48.5		Max OD	46.7
25%	43.2	50%	50.0	Surface Area (mm ²)	Max HT	28.0
30%	44.4	60%	52.8		Unwound Core:	3100
35%	45.9	70%	56.3		40% Wound:	4900

Coating Temp: (Continuous, up to; °C) 200 °C

Notes:

