

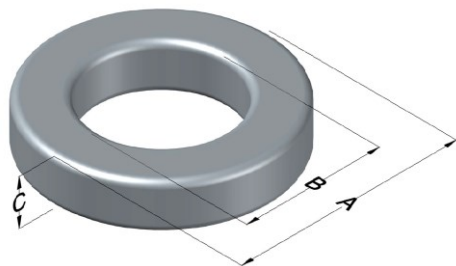

0076550A7

110 Delta Drive
 Pittsburgh, PA 15238
 NAFTA Sales: (1)800-245-3984
 HK Sales : (852)3102-9337
 magnetics@spang.com
 www.mag-inc.com



Kool M μ Hf Permeability (μ)	A _L (nH/T ²)	Core Marking			Coating Color
		Lot Number	Part Number	Inductance Grade	
26	28 ± 8%	XXXXXX	76550A7	N/A	Black

Dimensions					Packaging	
Uncoated			Coated Limits			
	(mm)	(in)	(mm)	(in)		
OD (A)	32.79	1.291	33.66	1.325	max	Cardboard cut-outs Box Qty = 250 Pcs
ID (B)	20.09	0.791	19.46	0.766	min	
HT (C)	10.67	0.420	11.43	0.450	max	

Electrical Characteristics			Physical Characteristics						
Watt Loss @ 100kHz, 100mT (max, mW/cm ³)	DC Bias min (Oersteds)		Voltage Breakdown wire-to-wire min (V _{AC})	Break Strength (min, kg)	Window Area, W _A (mm ²)	Cross Section, A _e (mm ²)	Path Length, L _e (mm)	Volume V _e (mm ³)	Weight (g)
	80%	50%							
625	130	245	2000	78.9	296	65.6	81.4	5340	31.5

Winding Information					Temperature Rating		
Winding Length per Turn			Wound Coil Dimensions (mm)			Curie Temp (°C):	
Winding Factor	(mm)	Winding Factor	(mm)	40% Winding Factor	OD	HT	500 °C
0%	37.4	40%	47.2	Completely Full Window	Max OD	46.7	Coating Temp: (Continuous, up to; °C) 200 °C
20%	42.4	45%	48.8		Max HT	28.0	
25%	43.5	50%	50.1	Surface Area (mm ²)			Notes:
30%	44.7	60%	53.2	Unwound Core:	3100		
35%	46.1	70%	56.7	40% Wound:	4900		

