

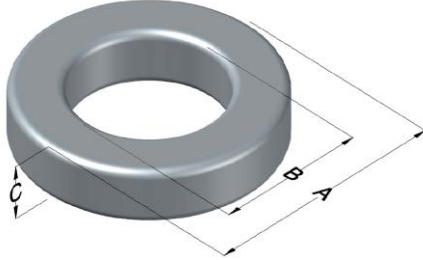

0076421A7

110 Delta Drive
 Pittsburgh, PA 15238
 NAFTA Sales: (1)800-245-3984
 HK Sales : (852)3102-9337
 magnetics@spang.com



Kool M μ Hf Permeability (μ)	A _L (nH/T ²)	Core Marking			Coating Color
		Lot Number	Part Number	Inductance Grade	
26	30 \pm 8%	XXXXXX	76421A7	N/A	Black

Dimensions	Uncoated		Coated Limits			Packaging
	(mm)	(in)	(mm)	(in)		
OD (A)	30.00	1.181	30.80	1.212	max	Cardboard cut-outs Box Qty = TBD
ID (B)	17.40	0.685	16.70	0.657	min	
HT (C)	10.90	0.429	11.80	0.464	max	

Electrical Characteristics			Physical Characteristics						
Watt Loss @ 100 kHz, 100 mT max (mW/cm ³)	DC Bias min (oersteds)		Voltage Breakdown wire to wire min (V _{AC})	Break Strength min (kg)	Window Area W _a (mm ²)	Cross Section A _e (mm ²)	Path Length L _e (mm)	Volume V _e (mm ³)	Est. Weight (g)
	80%	50%							
550	130	245	3000	TBD	219	66.5	72.7	4,840	29.3

Winding Information					Temperature Rating		
Winding Length Per Turn				Wound Coil Dimensions (mm)		Curie Temp: 500°C	
Winding Factor	(mm)	Winding Factor	(mm)	40% Winding Factor	OD	35.3	
					HT	20.7	
0%	37.7	40%	47.0	Completely Full Window	Max OD	35.3	
					Max HT	25.2	
20%	44.7	45%	48.7	Surface Area (mm ²)		Notes:	
25%	44.7	50%	50.1				
30%	44.7	60%	51.8	Unwound Core			2,800
35%	44.7	70%	55.7	40% Winding Factor			4,700

