

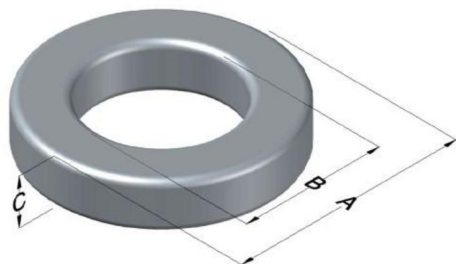

0076382A7

110 Delta Drive
 Pittsburgh, PA 15238
 NAFTA Sales: (1)800-245-3984
 HK Sales : (852)3102-9337
 magnetics@spang.com
 www.mag-inc.com



Kool M μ Hf Permeability (μ)	A _L (nH/T ²)	Core Marking			Coating Color
		Lot Number	Part Number	Inductance Grade	
26	19 \pm 8%	XXXXXX	76382A7	N/A	Black

Dimensions					Packaging	
Uncoated			Coated Limits			
	(mm)	(in)	(mm)	(in)		
OD (A)	17.27	0.680	18.03	0.710	max	Bulk Pack: 4 bags/box Box Qty = 2000 Pcs
ID (B)	9.65	0.380	9.02	0.355	min	
HT (C)	6.35	0.250	7.11	0.280	max	

Electrical Characteristics			Physical Characteristics						
Watt Loss @ 100kHz, 100mT (max, mW/cm ³)	DC Bias min (Oersteds)		Voltage Breakdown wire-to-wire min (V _{Ac})	Break Strength (min, kg)	Window Area, W _A (mm ²)	Cross Section, A _e (mm ²)	Path Length, L _e (mm)	Volume V _e (mm ³)	Weight (g)
	80%	50%							
550	130	245	>2000	28.1	63.8	23.2	41.4	960	6.3

Winding Information					Temperature Rating	
Winding Length per Turn				Wound Coil Dimensions (mm)		
Winding Factor	(mm)	Winding Factor	(mm)	40% Winding Factor	OD	19.6
					0%	23.2
20%	25.6	45%	28.6	Completely Full Window	Max OD	24.9
25%	26.2	50%	29.3		Max HT	16.3
30%	26.6	60%	30.8	Surface Area (mm ²)		
35%	27.4	70%	32.4	Unwound Core:	990	
				40% Wound:	1400	

Curie Temp (°C):	500 °C
Coating Temp: (Continuous, up to; °C)	200 °C

Notes:

Typical DC Bias Performance

