

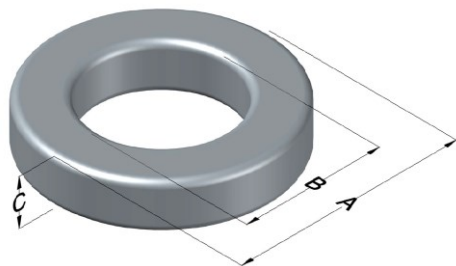

**0076351A7**

110 Delta Drive  
 Pittsburgh, PA 15238  
 NAFTA Sales: (1)800-245-3984  
 HK Sales : (852)3102-9337  
 magnetics@spang.com  
 www.mag-inc.com



Kool M $\mu$ Hf Permeability ( $\mu$ )	A <sub>L</sub> (nH/T <sup>2</sup> )	Core Marking			Coating Color
		Lot Number	Part Number	Inductance Grade	
60	51 $\pm$ 8%	XXXXXX	76351A7	N/A	Black

Dimensions					Packaging	
Uncoated			Coated Limits			
	(mm)	(in)	(mm)	(in)		
OD (A)	23.57	0.928	24.33	0.958	max	Cardboard cut-outs Box Qty = 720 Pcs
ID (B)	14.40	0.567	13.77	0.542	min	
HT (C)	8.89	0.350	9.65	0.380	max	

Electrical Characteristics			Physical Characteristics						
Watt Loss @ 100kHz, 100mT (max, mW/cm <sup>3</sup> )	DC Bias min (Oersteds)		Voltage Breakdown wire-to-wire min (V <sub>AC</sub> )	Break Strength (min, kg)	Window Area, W <sub>A</sub> (mm <sup>2</sup> )	Cross Section, A <sub>e</sub> (mm <sup>2</sup> )	Path Length, L <sub>e</sub> (mm)	Volume V <sub>e</sub> (mm <sup>3</sup> )	Weight (g)
	80%	50%							
525	45	100	1000	47.1	147	38.8	58.8	2280	14.7

Winding Information					Temperature Rating			
Winding Length per Turn			Wound Coil Dimensions (mm)			Curie Temp (°C):		500 °C
Winding Factor	(mm)	Winding Factor	(mm)	40% Winding Factor	OD	HT	Coating Temp: (Continuous, up to; °C)	200 °C
0%	29.8	40%	36.9	Completely Full Window	Max OD	33.5	Notes:	
20%	33.4	45%	38.0		Max HT	21.4		
25%	34.2	50%	38.9	Surface Area (mm <sup>2</sup> )				
30%	35.0	60%	41.1	Unwound Core:	1800			
35%	36.1	70%	43.6	40% Wound:	2700			

