

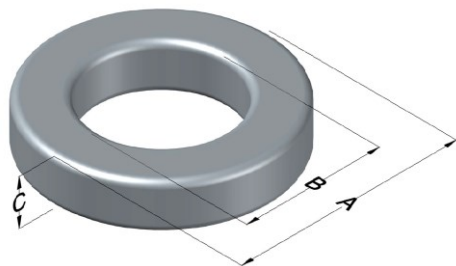

**0076326A7**

110 Delta Drive  
 Pittsburgh, PA 15238  
 NAFTA Sales: (1)800-245-3984  
 HK Sales : (852)3102-9337  
 magnetics@spang.com  
 www.mag-inc.com



Kool M $\mu$ Hf Permeability ( $\mu$ )	A <sub>L</sub> (nH/T <sup>2</sup> )	Core Marking			Coating Color
		Lot Number	Part Number	Inductance Grade	
26	24 ± 8%	XXXXXX	76326A7	N/A	Black

Dimensions					Packaging	
Uncoated			Coated Limits			
	(mm)	(in)	(mm)	(in)		
OD (A)	35.81	1.410	36.70	1.445	max	Cardboard cut-outs Box Qty = 220 Pcs
ID (B)	22.35	0.880	21.54	0.848	min	
HT (C)	10.46	0.412	11.35	0.447	max	

Electrical Characteristics			Physical Characteristics						
Watt Loss @ 100kHz, 100mT (max, mW/cm <sup>3</sup> )	DC Bias min (Oersteds)		Voltage Breakdown wire-to-wire min (V <sub>AC</sub> )	Break Strength (min, kg)	Window Area, W <sub>A</sub> (mm <sup>2</sup> )	Cross Section, A <sub>e</sub> (mm <sup>2</sup> )	Path Length, L <sub>e</sub> (mm)	Volume V <sub>e</sub> (mm <sup>3</sup> )	Weight (g)
	80%	50%							
625	130	245	2000	79.8	363	67.8	89.8	6090	35.9

Winding Information					Temperature Rating			
Winding Length per Turn			Wound Coil Dimensions (mm)			Curie Temp (°C):	500 °C	
Winding Factor	(mm)	Winding Factor	(mm)	40% Winding Factor	OD	40.2	Coating Temp: (Continuous, up to; °C)	200 °C
0%	37.9	40%	48.9	Completely Full Window	HT	18.4		
20%	43.5	45%	50.6		Max OD	51.1		
25%	44.8	50%	52.0	Max HT	29.6			
30%	46.0	60%	55.5	Surface Area (mm <sup>2</sup> )				
35%	47.6	70%	59.3	Unwound Core:	3400			
				40% Wound:	5700			

