

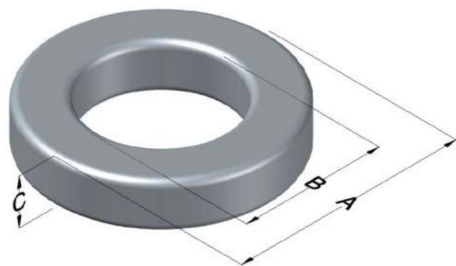

0076113A7

110 Delta Drive
 Pittsburgh, PA 15238
 NAFTA Sales: (1)800-245-3984
 HK Sales : (852)3102-9337
 magnetics@spang.com
 www.mag-inc.com



Kool M μ Hf Permeability (μ)	A _L (nH/T ²)	Core Marking			Coating Color
		Lot Number	Part Number	Inductance Grade	
40	24 \pm 8%	XXXXXX	76113A7	N/A	Black

Dimensions						Packaging
Uncoated			Coated Limits			
	(mm)	(in)	(mm)	(in)		
OD (A)	16.59	0.653	17.27	0.680	max	
ID (B)	10.16	0.400	9.53	0.375	min	
HT (C)	6.35	0.250	7.11	0.280	max	

Cardboard cut-outs
Box Qty = 2000 Pcs

Electrical Characteristics			Physical Characteristics						
Watt Loss @ 100kHz, 100mT (max, mW/cm ³)	DC Bias min (Oersteds)		Voltage Breakdown wire-to-wire min (V _{AC})	Break Strength (min, kg)	Window Area, W _A (mm ²)	Cross Section, A _e (mm ²)	Path Length, L _e (mm)	Volume V _e (mm ³)	Weight (g)
	80%	50%							
500	75.0	145	1250	23.1	71.2	19.2	41.2	791	6.83

Winding Information					Temperature Rating				
Winding Length per Turn				Wound Coil Dimensions (mm)		Curie Temp (°C):	500 °C		
Winding Factor	(mm)	Winding Factor	(mm)	40% Winding Factor	OD	18.8	Coating Temp: (Continuous, up to; °C)	200 °C	
					HT	10.1			
0%	22.0	40%	26.8	Completely Full Window	Max OD	23.7	Notes:		
20%	24.4	45%	27.6		Max HT	15.2			
25%	25.0	50%	28.3	Surface Area (mm ²)					
30%	25.6	60%	29.7	Unwound Core:	920				
35%	26.2	70%	31.4	40% Wound:	1300				

