

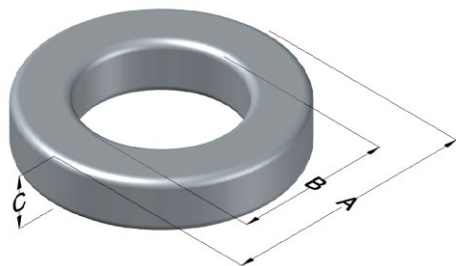

0076083A7

110 Delta Drive
 Pittsburgh, PA 15238
 NAFTA Sales: (1)800-245-3984
 HK Sales : (852)3102-9337
 magnetics@spang.com
 www.mag-inc.com



Kool M μ Hf Permeability (μ)	A _L (nH/T ²)	Core Marking			Coating Color
		Lot Number	Part Number	Inductance Grade	
60	81 ± 8%	XXXXXX	76083A7	N/A	Black

Dimensions					Packaging	
Uncoated			Coated Limits			
	(mm)	(in)	(mm)	(in)		
OD (A)	39.88	1.570	40.77	1.605	max	Cardboard cut-outs Box Qty = 180 Pcs
ID (B)	24.13	0.950	23.32	0.918	min	
HT (C)	14.48	0.570	15.37	0.605	max	

Electrical Characteristics			Physical Characteristics						
Watt Loss @ 100kHz, 100mT (max, mW/cm ³)	DC Bias min (Oersteds)		Voltage Breakdown wire-to-wire min (V _{AC})	Break Strength (min, kg)	Window Area, W _A (mm ²)	Cross Section, A _e (mm ²)	Path Length, L _e (mm)	Volume V _e (mm ³)	Weight (g)
	80%	50%							
525	45	100	2000	126.1	426	107	98.4	10500	67.9

Winding Information					Temperature Rating		
Winding Length per Turn			Wound Coil Dimensions (mm)			Curie Temp (°C):	
Winding Factor	(mm)	Winding Factor	(mm)	40% Winding Factor	OD	HT	500 °C
0%	48.2	40%	60.2	Completely Full Window	Max OD	56.4	Coating Temp: 200 °C (Continuous, up to; °C)
20%	54.3	45%	62.1		Max HT	35.2	
25%	55.8	50%	63.7	Surface Area (mm ²)			Notes:
30%	57.0	60%	67.3	Unwound Core:	4800		
35%	58.8	70%	71.5	40% Wound:	7300		

