

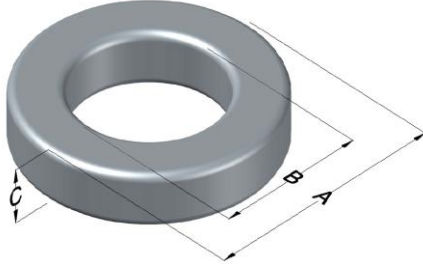

**0074439A7HT20**

110 Delta Drive  
 Pittsburgh, PA 15238  
 NAFTA Sales: (1)800-245-3984  
 HK Sales : (852)3102-9337  
 magnetics@spang.com



XFlux Ultra Permeability ( $\mu$ )	$A_L$ (nH/T <sup>2</sup> )	Core Marking			Coating Color
		Lot Number	Part Number	Inductance Grade	
60	148 ± 8%	XXXXXX	74439A7HT20	N/A	Brown

Dimensions	Uncoated		Coated Limits			Packaging
	(mm)	(in)	(mm)	(in)		
OD (A)	46.74	1.840	47.63	1.875	max	Cardboard cut-outs Box Qty= 90 pcs
ID (B)	24.13	0.950	23.32	0.918	min	
HT (C)	19.11	0.752	20.00	0.787	max	

Electrical Characteristics			Physical Characteristics						
Watt Loss @ 50 kHz, 100 mT max (mW/cm <sup>3</sup> )	DC Bias min (oersteds)		Voltage Breakdown wire to wire min (V <sub>AC</sub> )	Break Strength min (kg)	Window Area W <sub>a</sub> (mm <sup>2</sup> )	Cross Section A <sub>e</sub> (mm <sup>2</sup> )	Path Length L <sub>e</sub> (mm)	Volume V <sub>e</sub> (mm <sup>3</sup> )	Est. Weight (g)
	80%	50%							
575	90	160	3000	233	427	210.5	107.4	22,600	174

Winding Information					Temperature Rating		
Winding Length Per Turn				Wound Coil Dimensions (mm)		Curie Temp: 700°C	
Winding Factor	(mm)	Winding Factor	(mm)	40% Winding Factor		Coating Temp (Continuous up to): 200°C	
				OD	HT		
0%	64.3	40%	76.3	Completely Full Window	Max OD	Notes:	
20%	70.4	45%	78.2		Max HT		36.8
25%	71.8	50%	79.8	Surface Area (mm <sup>2</sup> )			
30%	73.2	60%	83.5	Unwound Core			7,200
35%	75.0	70%	87.8	40% Winding Factor			9,800

**Typical DC Bias Performance**

