

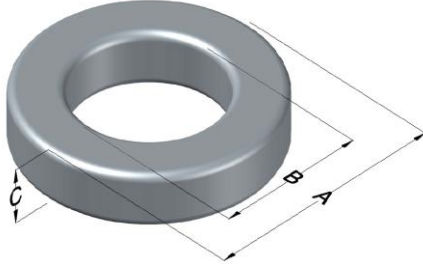

0074083A7HT20

110 Delta Drive
 Pittsburgh, PA 15238
 NAFTA Sales: (1)800-245-3984
 HK Sales : (852)3102-9337
 magnetics@spang.com



XFlux Ultra Permeability (μ)	A_L (nH/T ²)	Core Marking			Coating Color
		Lot Number	Part Number	Inductance Grade	
60	110 ± 8%	XXXXXX	74083A7HT20	N/A	Brown

Dimensions	Uncoated		Coated Limits			Packaging
	(mm)	(in)	(mm)	(in)		
OD (A)	39.88	1.570	40.77	1.605	max	Cardboard cut-outs Box Qty = TBD
ID (B)	24.13	0.950	23.32	0.918	min	
HT (C)	19.11	0.752	20.00	0.787	max	

Electrical Characteristics			Physical Characteristics						
Watt Loss @ 50 kHz, 100 mT max (mW/cm ³)	DC Bias min (oersteds)		Voltage Breakdown wire to wire min (V _{AC})	Break Strength min (kg)	Window Area W _a (mm ²)	Cross Section A _e (mm ²)	Path Length L _e (mm)	Volume V _e (mm ³)	Est. Weight (g)
	80%	50%							
575	90	160	3000	126	427	143.8	98.4	14,200	110

Winding Information					Temperature Rating	
Winding Length Per Turn				Wound Coil Dimensions (mm)		Curie Temp: 700°C
Winding Factor	(mm)	Winding Factor	(mm)	40% Winding Factor		Coating Temp (Continuous up to): 200°C
				OD	45.6	Notes:
Completely Full Window	HT	27.2				
	Max OD	48.0				
Max HT	36.8					
Surface Area (mm ²)						
Unwound Core					5,800	
40% Winding Factor					8,100	

