

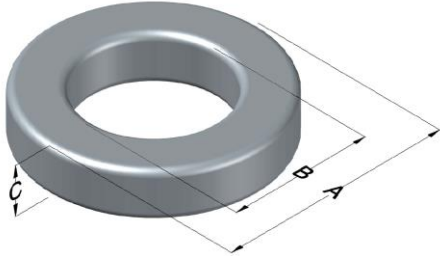

**0070716A7**

110 Delta Drive  
 Pittsburgh, PA 15238  
 NAFTA Sales: (1)800-245-3984  
 HK Sales : (852)3102-9337  
 magnetics@spang.com



Kool M $\mu$ Ultra Permeability ( $\mu$ )	A <sub>L</sub> (nH/T <sup>2</sup> )	Core Marking			Coating Color
		Lot Number	Part Number	Inductance Grade	
60	73 $\pm$ 8%	XXXXXX	70716A7	N/A	Black

Dimensions	Uncoated		Coated Limits			Packaging
	(mm)	(in)	(mm)	(in)		
OD (A)	50.80	2.00	51.69	2.04	max	Cardboard cut-outs Box Qty= 90 pcs
ID (B)	31.75	1.25	30.94	1.22	min	
HT (C)	13.46	0.53	14.35	0.57	max	

Electrical Characteristics			Physical Characteristics						
Watt Loss @ 100 kHz, 100 mT max (mW/cm <sup>3</sup> )	DC Bias min (oersteds)		Voltage Breakdown wire to wire min (V <sub>AC</sub> )	Break Strength min (kg)	Window Area W <sub>a</sub> (mm <sup>2</sup> )	Cross Section A <sub>e</sub> (mm <sup>2</sup> )	Path Length L <sub>e</sub> (mm)	Volume V <sub>e</sub> (mm <sup>3</sup> )	Est. Weight (g)
	80%	50%							
250	45	100	3000	93.0	752	125	127	15,900	TBD

Winding Information					Temperature Rating	
Winding Length Per Turn				Wound Coil Dimensions (mm)		Curie Temp: 500°C
Winding Factor	(mm)	Winding Factor	(mm)	40% Winding Factor		Notes:
				OD	HT	
0%	49.5	40%	65.7	Completely Full Window		
				Max OD	Max HT	
20%	56.4	45%	68.1	Surface Area (mm <sup>2</sup> )		
25%	59.6	50%	70.3	Unwound Core		
30%	61.8	60%	75.3	40% Winding Factor		
35%	63.6	70%	80.9			

**Typical DC Bias Performance**

