

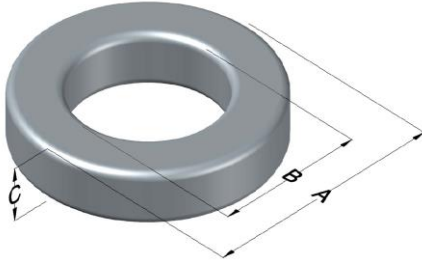

**0070423A7**

110 Delta Drive  
 Pittsburgh, PA 15238  
 NAFTA Sales: (1)800-245-3984  
 HK Sales : (852)3102-9337  
 magnetics@spang.com



Kool M $\mu$ Ultra Permeability ( $\mu$ )	A <sub>L</sub> (nH/T <sup>2</sup> )	Core Marking			Coating Color
		Lot Number	Part Number	Inductance Grade	
60	69 ± 8%	XXXXXX	70423A7	N/A	Black

Dimensions	Uncoated		Coated Limits			Packaging
	(mm)	(in)	(mm)	(in)		
OD (A)	30.00	1.181	30.80	1.212	max	Cardboard cut-outs Box Qty = TBD
ID (B)	17.40	0.685	16.70	0.657	min	
HT (C)	10.90	0.429	11.80	0.464	max	

Electrical Characteristics			Physical Characteristics						
Watt Loss @ 100 kHz, 100 mT max (mW/cm <sup>3</sup> )	DC Bias min (oersteds)		Voltage Breakdown wire to wire min (V <sub>AC</sub> )	Break Strength min (kg)	Window Area W <sub>a</sub> (mm <sup>2</sup> )	Cross Section A <sub>e</sub> (mm <sup>2</sup> )	Path Length L <sub>e</sub> (mm)	Volume V <sub>e</sub> (mm <sup>3</sup> )	Est. Weight (g)
	80%	50%							
250	45	100	3000	TBD	219	66.5	72.7	4,840	TBD

Winding Information					Temperature Rating	
Winding Length Per Turn				Wound Coil Dimensions (mm)		Curie Temp: 500°C
Winding Factor	(mm)	Winding Factor	(mm)	40% Winding Factor		Notes:
				OD	35.3	
0%	37.7	40%	47.0	HT	20.7	
				Completely Full Window		
20%	44.7	45%	48.7	Max HT	25.2	
25%	44.7	50%	50.1	Surface Area (mm <sup>2</sup> )		
30%	44.7	60%	51.8	Unwound Core	2,800	
35%	44.7	70%	55.7	40% Winding Factor	4,700	

