

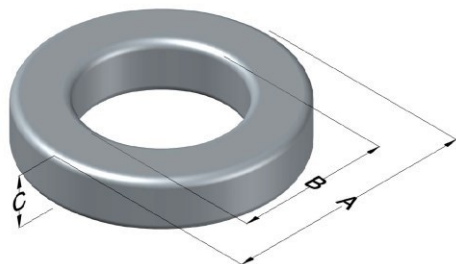

0059550A2

110 Delta Drive
 Pittsburgh, PA 15238
 NAFTA Sales: (1)800-245-3984
 HK Sales : (852)3102-9337
 magnetics@spang.com
 www.mag-inc.com



Edge Permeability (μ)	A_L (nH/T ²)	Core Marking			Coating Color
		Lot Number	Part Number	Inductance Grade	
26	28 ± 8%	XXXXXX	59550A2	N/A	Green

Dimensions					Packaging	
	Uncoated		Coated Limits			
	(mm)	(in)	(mm)	(in)		
OD (A)	32.79	1.291	33.66	1.325	max	
ID (B)	20.09	0.791	19.46	0.766	min	
HT (C)	10.67	0.420	11.43	0.450	max	

Cardboard cut-outs
Box Qty = 250 Pcs

Electrical Characteristics			Physical Characteristics						
Watt Loss @ 100kHz, 100mT (max, mW/cm ³)	DC Bias min (Oersteds)		Voltage Breakdown wire-to-wire min (V _{AC})	Break Strength (min, kg)	Window Area, W _A (mm ²)	Cross Section, A _e (mm ²)	Path Length, L _e (mm)	Volume V _e (mm ³)	Weight (g)
	80%	50%							
725	240	350	2000	78.9	296	65.6	81.4	5340	38.4

Winding Information					Temperature Rating			
Winding Length per Turn				Wound Coil Dimensions (mm)		Curie Temp (°C):	500 °C	
Winding Factor	(mm)	Winding Factor	(mm)	40% Winding Factor	OD			
0%	37.4	40%	47.2	Completely Full Window	HT	36.8	Coating Temp: (Continuous, up to; °C)	200 °C
20%	42.4	45%	48.8		Max OD	46.7		
25%	43.5	50%	50.1	Surface Area (mm ²)		Notes:		
30%	44.7	60%	53.2	Unwound Core:	3100			
35%	46.1	70%	56.7	40% Wound:	4900			

