

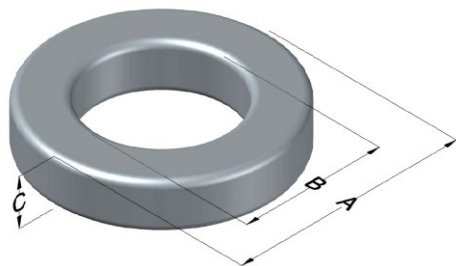

0059326A2

110 Delta Drive
 Pittsburgh, PA 15238
 NAFTA Sales: (1)800-245-3984
 HK Sales : (852)3102-9337
 magnetics@spang.com
 www.mag-inc.com



Edge Permeability (μ)	A_L (nH/T ²)	Core Marking			Coating Color
		Lot Number	Part Number	Inductance Grade	
26	24 \pm 8%	XXXXXX	59326A2	N/A	Green

Dimensions					Packaging	
Uncoated			Coated Limits			
	(mm)	(in)	(mm)	(in)		
OD (A)	35.81	1.410	36.70	1.445	max	Cardboard cut-outs Box Qty = 220 Pcs
ID (B)	22.35	0.880	21.54	0.848	min	
HT (C)	10.46	0.412	11.35	0.447	max	

Electrical Characteristics			Physical Characteristics						
Watt Loss @ 100kHz, 100mT (max, mW/cm ³)	DC Bias min (Oersteds)		Voltage Breakdown wire-to-wire min (V _{AC})	Break Strength (min, kg)	Window Area, W _A (mm ²)	Cross Section, A _e (mm ²)	Path Length, L _e (mm)	Volume V _e (mm ³)	Weight (g)
	80%	50%							
725	240	350	2000	79.8	363	67.8	89.8	6090	43.8

Winding Information					Temperature Rating			
Winding Length per Turn			Wound Coil Dimensions (mm)			Curie Temp (°C):	500 °C	
Winding Factor	(mm)	Winding Factor	(mm)	40% Winding Factor	OD	40.2	Coating Temp: (Continuous, up to; °C)	200 °C
0%	37.9	40%	48.9	Completely Full Window	HT	18.4		
20%	43.5	45%	50.6		Max OD	51.1		
25%	44.8	50%	52.0	Max HT	29.6			
30%	46.0	60%	55.5	Surface Area (mm ²)				
35%	47.6	70%	59.3	Unwound Core:	3400			
				40% Wound:	5700			

