

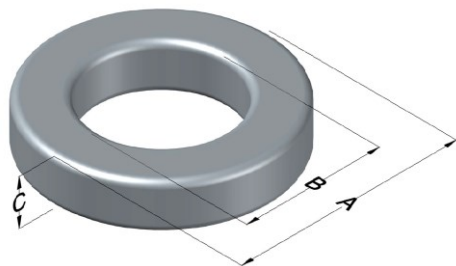

0059312A2

110 Delta Drive
 Pittsburgh, PA 15238
 NAFTA Sales: (1)800-245-3984
 HK Sales : (852)3102-9337
 magnetics@spang.com
 www.mag-inc.com



Edge Permeability (μ)	A_L (nH/T ²)	Core Marking			Coating Color
		Lot Number	Part Number	Inductance Grade	
26	19 ± 8%	XXXXXX	59312A2	N/A	Green

Dimensions					Packaging	
Uncoated			Coated Limits			
	(mm)	(in)	(mm)	(in)		
OD (A)	22.86	0.900	23.62	0.930	max	Cardboard cut-outs Box Qty = 1000 Pcs
ID (B)	13.97	0.550	13.34	0.525	min	
HT (C)	7.62	0.300	8.38	0.330	max	

Electrical Characteristics			Physical Characteristics						
Watt Loss @ 100kHz, 100mT (max, mW/cm ³)	DC Bias min (Oersteds)		Voltage Breakdown wire-to-wire min (V _{AC})	Break Strength (min, kg)	Window Area, W _A (mm ²)	Cross Section, A _e (mm ²)	Path Length, L _e (mm)	Volume V _e (mm ³)	Weight (g)
	80%	50%							
725	240	350	1000	39.4	139	31.7	56.7	1800	12.9

Winding Information					Temperature Rating		
Winding Length per Turn			Wound Coil Dimensions (mm)			Curie Temp (°C):	500 °C
Winding Factor	(mm)	Winding Factor	(mm)	40% Winding Factor	OD	25.7	
					HT	12.4	
0%	27.0	40%	33.9	Completely Full Window	Max OD	32.6	
20%	30.5	45%	34.9		Max HT	19.8	
25%	31.3	50%	35.9	Surface Area (mm ²)			Notes:
30%	32.0	60%	38.0	Unwound Core:	1600		
35%	33.1	70%	40.4	40% Wound:	2400		

