

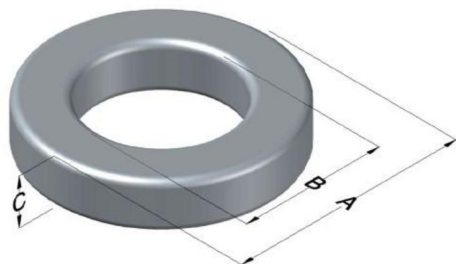

0059208A2

110 Delta Drive
 Pittsburgh, PA 15238
 NAFTA Sales: (1)800-245-3984
 HK Sales : (852)3102-9337
 magnetics@spang.com
 www.mag-inc.com



Edge Permeability (μ)	A_L (nH/T ²)	Core Marking			Coating Color
		Lot Number	Part Number	Inductance Grade	
26	14 \pm 8%	XXXXXX	59208A2	N/A	Green

Dimensions					Packaging	
Uncoated			Coated Limits			
	(mm)	(in)	(mm)	(in)		
OD (A)	20.32	0.800	21.08	0.830	max	Bulk Pack: 4 bags/box Box Qty = 1600 Pcs
ID (B)	12.70	0.500	12.07	0.475	min	
HT (C)	6.35	0.250	7.11	0.280	max	

Electrical Characteristics			Physical Characteristics						
Watt Loss @ 100kHz, 100mT (max, mW/cm ³)	DC Bias min (Oersteds)		Voltage Breakdown wire-to-wire min (V _{AC})	Break Strength (min, kg)	Window Area, W _A (mm ²)	Cross Section, A _e (mm ²)	Path Length, L _e (mm)	Volume V _e (mm ³)	Weight (g)
725	80%	50%							

Winding Information					Temperature Rating	
Winding Length per Turn				Wound Coil Dimensions (mm)		
Winding Factor	(mm)	Winding Factor	(mm)	40% Winding Factor	OD	HT
0%	23.2	40%	29.3	Completely Full Window	Max OD	29.2
20%	26.3	45%	30.3		Max HT	17.4
25%	27.0	50%	31.2	Surface Area (mm ²)		
30%	27.8	60%	32.9	Unwound Core: 1200		
35%	28.6	70%	35.1	40% Wound: 1900		

Curie Temp (°C):	500 °C
Coating Temp: (Continuous, up to; °C)	200 °C

Notes:

Typical DC Bias Performance

