

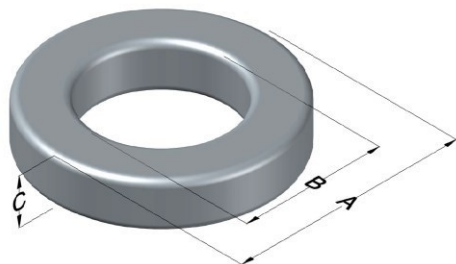

0059121A2

110 Delta Drive
 Pittsburgh, PA 15238
 NAFTA Sales: (1)800-245-3984
 HK Sales : (852)3102-9337
 magnetics@spang.com
 www.mag-inc.com



Edge Permeability (μ)	A_L (nH/T ²)	Core Marking			Coating Color
		Lot Number	Part Number	Inductance Grade	
60	35 \pm 8%	XXXXXX	59121A2	N/A	Green

Dimensions					Packaging
Uncoated		Coated Limits			
	(mm)	(in)	(mm)	(in)	
OD (A)	16.59	0.653	17.27	0.680	max
ID (B)	10.16	0.400	9.53	0.375	min
HT (C)	6.35	0.250	7.11	0.280	max

Cardboard cut-outs
Box Qty = 2000 Pcs

Electrical Characteristics			Physical Characteristics						
Watt Loss @ 100kHz, 100mT (max, mW/cm ³)	DC Bias min (Oersteds)		Voltage Breakdown wire-to-wire min (V _{Ac})	Break Strength (min, kg)	Window Area, W _A (mm ²)	Cross Section, A _e (mm ²)	Path Length, L _e (mm)	Volume V _e (mm ³)	Weight (g)
	80%	50%							
525	100	180	1000	23.1	71.2	19.2	41.2	791	6.4

Winding Information					Temperature Rating		
Winding Length per Turn				Wound Coil Dimensions (mm)		Curie Temp (°C):	500 °C
Winding Factor	(mm)	Winding Factor	(mm)	40% Winding Factor	OD	18.8	
					HT	10.1	
0%	22.1	40%	27.0	Completely Full Window	Max OD	23.7	
20%	24.6	45%	27.7		Max HT	15.2	
25%	25.2	50%	28.4	Surface Area (mm ²)			
30%	25.6	60%	29.8	Unwound Core:	920		
35%	26.4	70%	31.5	40% Wound:	1300		

Coating Temp: (Continuous, up to; °C) 200 °C

Notes:

