

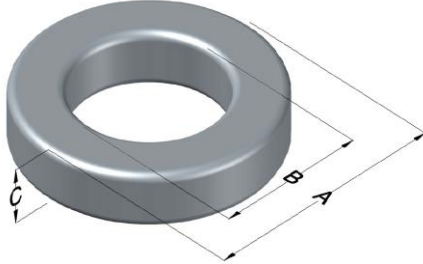

0059071A2HT25

110 Delta Drive
 Pittsburgh, PA 15238
 NAFTA Sales: (1)800-245-3984
 HK Sales : (852)3102-9337
 magnetics@spang.com



Edge Permeability (μ)	A_L (nH/T ²)	Core Marking			Coating Color
		Lot Number	Part Number	Inductance Grade	
60	139 ± 8%	XXXXXX	59071A2HT25	N/A	Green

Dimensions	Uncoated		Coated Limits			Packaging
	(mm)	(in)	(mm)	(in)		
OD (A)	32.79	1.291	33.66	1.325	max	Cardboard cut-outs Box Qty = TBD
ID (B)	20.09	0.791	19.46	0.766	min	
HT (C)	23.99	0.944	25.00	0.984	max	

Electrical Characteristics			Physical Characteristics						
Watt Loss @ 100 kHz, 100 mT max (mW/cm ³)	DC Bias min (oersteds)		Voltage Breakdown wire to wire min (V _{AC})	Break Strength min (kg)	Window Area W _a (mm ²)	Cross Section A _e (mm ²)	Path Length L _e (mm)	Volume V _e (mm ³)	Est. Weight (g)
	80%	50%							
525	100	180	3000	79.0	297	150	81.4	12,200	100

Winding Information					Temperature Rating	
Winding Length Per Turn				Wound Coil Dimensions (mm)		Curie Temp: 500°C
Winding Factor	(mm)	Winding Factor	(mm)	40% Winding Factor		Notes:
				OD	37.7	
0%	64.2	40%	74.2	HT	31.0	
				Max OD	39.7	
20%	69.3	45%	75.8	Max HT	39.0	
25%	70.5	50%	77.1	Surface Area (mm ²)		
30%	71.6	60%	80.3	Unwound Core	5,400	
35%	73.1	70%	83.9	40% Winding Factor	6,900	

