

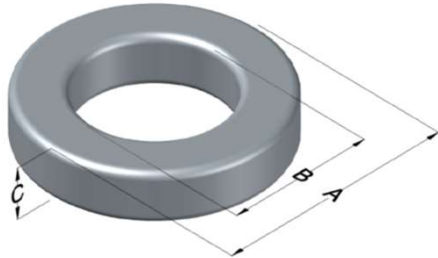

0058913A2

110 Delta Drive
 Pittsburgh, PA 15238
 NAFTA Sales: (1)800-245-3984
 HK Sales : (852)3102-9337
 magnetics@spang.com
 www.mag-inc.com



High Flux Permeability (μ)	A_L (nH/T ²)	Core Marking			Coating Color
		Lot Number	Part Number	Inductance Grade	
19	27 ± 8%	XXXXXX	58913A2	N/A	Khaki

Dimensions	Uncoated		Coated Limits			Packaging
	(mm)	(in)	(mm)	(in)		
OD (A)	77.80	3.063	78.94	3.108	max	Cardboard cut-outs Box Qty= 40 pcs
ID (B)	49.23	1.938	48.21	1.898	min	
HT (C)	15.88	0.625	17.02	0.670	max	

Electrical Characteristics			Physical Characteristics						
Watt Loss @ 100kHz, 100mT max (mW/cm ³)	DC Bias min (oersteds)		Voltage Breakdown wire to wire min (V _{AC})	Break Strength min (kg)	Window Area W _a (mm ²)	Cross Section A _e (mm ²)	Path Length L _e (mm)	Volume V _e (mm ³)	Weight (g)
	80%	50%							
1800	240	475	3000	141.0	1,830	221	196.1	43,400	241

Winding Information					Temperature Rating	
Winding Length Per Turn				Wound Coil Dimensions (mm)		Curie Temp: 500°C
Winding Factor	(mm)	Winding Factor	(mm)	40% Winding Factor	OD	88.9
					HT	32.0
0%	64.8	40%	89.4	Completely Full Window	Max OD	93.9
20%	77.3	45%	93.2		Max HT	52.0
25%	80.2	50%	96.5	Surface Area (mm ²)		
30%	82.8	60%	104	Unwound Core	13,000	
35%	86.7	70%	113	40% Winding Factor	23,000	
Coating Temp (Continuous up to): 200°C						
Notes:						

