

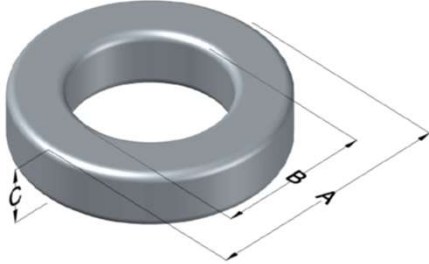

0058596A2

110 Delta Drive
 Pittsburgh, PA 15238
 NAFTA Sales: (1)800-245-3984
 HK Sales : (852)3102-9337
 magnetics@spang.com



High Flux Permeability (μ)	A_L (nH/T ²)	Core Marking			Coating Color
		Lot Number	Part Number	Inductance Grade	
125	259 ± 8%	XXXXXX	58596A2	N/A	Khaki

Dimensions	Uncoated		Coated Limits			Packaging
	(mm)	(in)	(mm)	(in)		
OD (A)	59.60	2.346	60.60	2.385	max	Cardboard cut-outs Box Qty= 63 pcs
ID (B)	34.00	1.338	33.00	1.299	min	
HT (C)	19.50	0.767	20.50	0.807	max	

Electrical Characteristics			Physical Characteristics						
Watt Loss @ 100kHz, 100mT max (mW/cm ³)	DC Bias min (oersteds)		Voltage Breakdown wire to wire min (V _{AC})	Break Strength min (kg)	Window Area W _a (mm ²)	Cross Section A _e (mm ²)	Path Length L _e (mm)	Volume V _e (mm ³)	Est. Weight (g)
	80%	50%							
1000	46	81	3000	154	855	237	143	33,900	277

Winding Information					Temperature Rating	
Winding Length Per Turn				Wound Coil Dimensions (mm)		Curie Temp: 500°C
Winding Factor	(mm)	Winding Factor	(mm)	40% Winding Factor	OD	67.4
					HT	30.7
0%	68.6	40%	85.5	Completely Full Window	Max OD	70.8
					Max HT	44.3
20%	77.3	45%	88.2	Surface Area (mm ²)		Notes:
25%	79.2	50%	90.5			
30%	81.2	60%	95.8	Unwound Core	10,000	
35%	83.6	70%	102	40% Winding Factor	15,000	
Coating Temp (Continuous up to): 200°C						

