

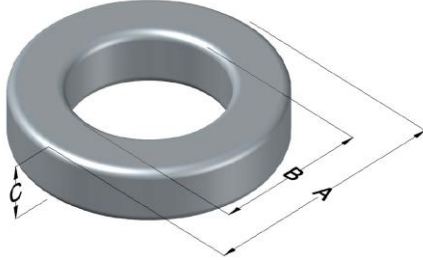

**0058421A2**

110 Delta Drive  
 Pittsburgh, PA 15238  
 NAFTA Sales: (1)800-245-3984  
 HK Sales : (852)3102-9337  
 magnetics@spang.com



High Flux Permeability ( $\mu$ )	$A_L$ (nH/T <sup>2</sup> )	Core Marking			Coating Color
		Lot Number	Part Number	Inductance Grade	
26	30 ± 8%	XXXXXX	58421A2	N/A	Khaki

Dimensions	Uncoated		Coated Limits			Packaging
	(mm)	(in)	(mm)	(in)		
OD (A)	30.00	1.181	30.80	1.212	max	Cardboard cut-outs Box Qty = TBD
ID (B)	17.40	0.685	16.70	0.657	min	
HT (C)	10.90	0.429	11.80	0.464	max	

Electrical Characteristics			Physical Characteristics						
Watt Loss @ 100 kHz, 100 mT max (mW/cm <sup>3</sup> )	DC Bias min (oersteds)		Voltage Breakdown wire to wire min (V <sub>AC</sub> )	Break Strength min (kg)	Window Area W <sub>a</sub> (mm <sup>2</sup> )	Cross Section A <sub>e</sub> (mm <sup>2</sup> )	Path Length L <sub>e</sub> (mm)	Volume V <sub>e</sub> (mm <sup>3</sup> )	Est. Weight (g)
	80%	50%							
1250	200	375	3000	TBD	219	66.5	72.7	4,840	37.2

Winding Information					Temperature Rating		
Winding Length Per Turn				Wound Coil Dimensions (mm)		Curie Temp: 500°C	
Winding Factor	(mm)	Winding Factor	(mm)	40% Winding Factor	OD	35.3	
					HT	20.7	
0%	37.7	40%	47.0	Completely Full Window	Max OD	35.3	
					Max HT	25.2	
20%	44.7	45%	48.7	Surface Area (mm <sup>2</sup> )		Notes:	
25%	44.7	50%	50.1				
30%	44.7	60%	51.8	Unwound Core			2,800
35%	44.7	70%	55.7	40% Winding Factor			4,700

