

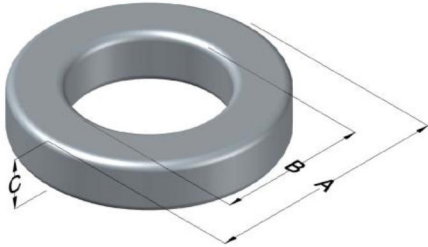

0055551A2

110 Delta Drive
 Pittsburgh, PA 15238
 NAFTA Sales: (1)800-245-3984
 HK Sales : (852)3102-9337
 magnetics@spang.com
 www.mag-inc.com



MPP Permeability (μ)	A_L (nH/T ²)	Core Marking			Coating Color
		Lot Number	Part Number	Inductance Grade	
14	14 \pm 8%	XXXXXX	55551A2	N/A	Gray

Dimensions	Uncoated		Coated Limits			Packaging
	(mm)	(in)	(mm)	(in)		
OD (A)	33.36	1.313	33.66	1.325	max	Cardboard cut-outs Box Qty= 250 pcs
ID (B)	19.82	0.780	19.46	0.766	min	
HT (C)	11.10	0.437	11.43	0.450	max	

Electrical Characteristics			Physical Characteristics						
Watt Loss @ 100 kHz, 100mT max (mW/cm ³)	DC Bias min (oersteds)		Voltage Breakdown wire to wire min (V _{AC})	Break Strength min (kg)	Window Area W _A (mm ²)	Cross Section A _e (mm ²)	Path Length L _e (mm)	Volume V _e (mm ³)	Weight (g)
	80%	70%							
1600	215	270	3000	79.0	297	65.6	81.4	5340	38

Winding Information					Temperature Rating	
Winding Length Per Turn				Wound Coil Dimensions (mm)		Curie Temp: 460 °C
Winding Factor	(mm)	Winding Factor	(mm)	40% Winding Factor		Coating Temp (Continuous up to): 200 °C
				OD	36.8	Notes:
				HT	17.8	
				Completely Full Window		
				Max OD	46.7	
				Max HT	28.0	
				Surface Area (mm ²)		
				Unwound Core		3,100
				40% Winding Factor		4,900

