

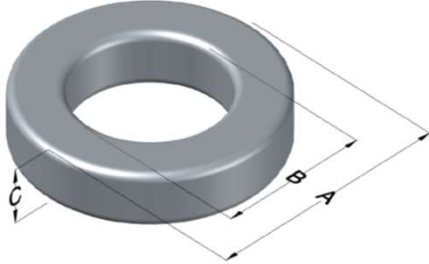

0055540A2

110 Delta Drive
 Pittsburgh, PA 15238
 NAFTA Sales: (1)800-245-3984
 HK Sales : (852)3102-9337
 magnetics@spang.com



MPP Permeability (μ)	A_L (nH/T ²)	Core Marking			Coating Color
		Lot Number	Part Number	Inductance Grade	
125	217 ± 8%	XXXXXX	55540A2	N/A	Grey

Dimensions	Uncoated		Coated Limits			Packaging
	(mm)	(in)	(mm)	(in)		
OD (A)	54.00	2.125	54.90	2.161	max	Cardboard cut-outs Box Qty= 90 pcs
ID (B)	29.00	1.141	28.10	1.106	min	
HT (C)	14.40	0.567	15.30	0.602	max	

Electrical Characteristics			Physical Characteristics						
Watt Loss @ 100kHz, 100mT max (mW/cm ³)	DC Bias min (oersteds)		Voltage Breakdown wire to wire min (V _{AC})	Break Strength min (kg)	Window Area W _a (mm ²)	Cross Section A _e (mm ²)	Path Length L _e (mm)	Volume V _e (mm ³)	Est. Weight (g)
	850	80%							
	25	48.5	3000	113.0	620	174	126	22,000	181

Winding Information					Temperature Rating	
Winding Length Per Turn				Wound Coil Dimensions (mm)		Curie Temp: 460°C
Winding Factor	(mm)	Winding Factor	(mm)	40% Winding Factor		Coating Temp (Continuous up to): 200°C
				OD	60.9	
				HT	24.3	Notes:
				Completely Full Window		
				Max OD	63.9	
0%	57.4	40%	72.0	Max HT	36.3	
				Surface Area (mm ²)		
20%	64.7	45%	74.0	Unwound Core		7,500
25%	66.5	50%	76.1	40% Winding Factor		11,000
30%	67.9	60%	80.5			
35%	70.2	70%	85.5			

