

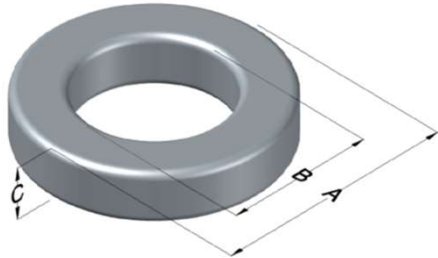

**0055396A2**

110 Delta Drive  
 Pittsburgh, PA 15238  
 NAFTA Sales: (1)800-245-3984  
 HK Sales : (852)3102-9337  
 magnetics@spang.com  
 www.mag-inc.com



MPP Permeability ( $\mu$ )	$A_L$ (nH/T <sup>2</sup> )	Core Marking			Coating Color
		Lot Number	Part Number	Inductance Grade	
147	299 ± 8%	XXXXXX	55396A2	N/A	Grey

Dimensions	Uncoated		Coated Limits			Packaging
	(mm)	(in)	(mm)	(in)		
OD (A)	40.13	1.580	40.94	1.612	max	Cardboard cut-outs Box Qty= 160 pcs
ID (B)	22.08	0.869	21.27	0.837	min	
HT (C)	17.00	0.669	17.89	0.704	max	

Electrical Characteristics			Physical Characteristics						
Watt Loss @ 100kHz, 100mT max (mW/cm <sup>3</sup> )	DC Bias min (oersteds)		Voltage Breakdown wire to wire min (V <sub>AC</sub> )	Break Strength min (kg)	Window Area W <sub>a</sub> (mm <sup>2</sup> )	Cross Section A <sub>e</sub> (mm <sup>2</sup> )	Path Length L <sub>e</sub> (mm)	Volume V <sub>e</sub> (mm <sup>3</sup> )	Weight (g)
	80%	50%							
900	23	43	3000	450	355	153	95	14,600	119

Winding Information					Temperature Rating	
Winding Length Per Turn				Wound Coil Dimensions (mm)		Curie Temp: 460°C
Winding Factor	(mm)	Winding Factor	(mm)	40% Winding Factor	OD	45.3
					HT	24.5
0%	55.5	40%	66.4	Completely Full Window	Max OD	47.5
20%	61.0	45%	68.1		Max HT	33.3
25%	62.3	50%	69.5	Surface Area (mm <sup>2</sup> )		
30%	63.5	60%	72.8	Unwound Core		5,400
35%	65.1	70%	76.7	40% Winding Factor		7,500
Coating Temp (Continuous up to): 200°C						
Notes:						

