

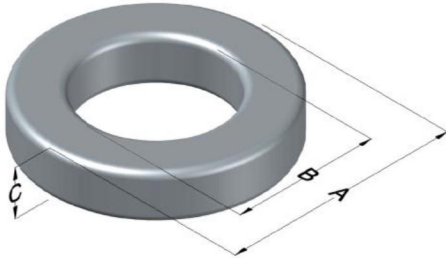

0055272A2

110 Delta Drive
 Pittsburgh, PA 15238
 NAFTA Sales: (1)800-245-3984
 HK Sales : (852)3102-9337
 magnetics@spang.com
 www.mag-inc.com



MPP Permeability (μ)	A_L (nH/T ²)	Core Marking			Coating Color
		Lot Number	Part Number	Inductance Grade	
26	21 ± 8%	XXXXXX	272	N/A	Gray

Dimensions	Uncoated		Coated Limits			Packaging
	(mm)	(in)	(mm)	(in)		
OD (A)	6.60	0.260	7.24	0.285	max	Bulk Pack 4 bags/box Box Qty= 10,000 pcs
ID (B)	2.67	0.105	2.16	0.085	min	
HT (C)	4.78	0.188	5.41	0.213	max	

Electrical Characteristics			Physical Characteristics						
Watt Loss @ 100 kHz, 100mT max(mW/cm ³)	DC Bias min (oersteds)		Voltage Breakdown wire to wire min (V _{AC})	Break Strength min (kg)	Window Area W _A (mm ²)	Cross Section A _e (mm ²)	Path Length L _e (mm)	Volume V _e (mm ³)	Weight (g)
	800	80% 120							

Winding Information					Temperature Rating				
Winding Length Per Turn				Wound Coil Dimensions (mm)			Curie Temp: 460°C		
Winding Factor	(mm)	Winding Factor	(mm)	40% Winding Factor	OD	7.41			
					HT	6.11			
0%	15.9	40%	17.0	Completely Full Window	Max OD	9.17			
					Max HT	7.42			
20%	16.4	45%	17.2	Surface Area (mm ²)					
25%	16.6	50%	17.3						
30%	16.7	60%	17.7						
35%	16.9	70%	18.0	Unwound Core	230				
				40% Winding Factor	260				
								Notes:	
								Coating Temp (Continuous up to): 200°C	

Typical DC Bias Performance

